

- > **Port size: 1/4" ... 1/2" (ISO G/PTF)**
- > **Excelon design allows in-line or modular installation**
- > **Push to lock adjusting knob with optional tamper resistant accessory**



### Technical features

#### Medium:

Compressed air only

#### Maximum operating pressure:

20 bar (300 psi)

#### Pressure range:

Standard

0,3 ... 10 bar (4 ... 145 psi)

Optional

0,3 ... 4 bar (4 ... 58 psi)

0,7 ... 17 bar (10 ... 250 psi)

#### Port size:

G1/4, G3/8, G1/2,  
1/4 PTF, 3/8 PTF 1/2 PTF

#### Gauge port:

Rc 1/8 with ISO G main ports  
1/4 PTF with PTF main ports

#### Flow:

60 dm<sup>3</sup>/s maximum

At port size: 3/8"

Inlet pressure 10 bar (145 psi);

6,3 bar (91 psi) set pressure and a

Δp: 1 bar (14,5 psi) droop from set

#### Non-return valve:

R73G – without return valve

R73R – with return valve

#### Ambient/Media temperature:

-34° ... +80°C (-30° ... +176°F)

Version with gauge:

-34° ... +65°C (-30° ... +149°F)

Air supply must be dry enough

to avoid ice formation at

temperatures below +2°C (+35°F).

#### Materials:

Body: Die cast aluminium

Bottom plug: Acetal

Metal bonnet: Zinc

Elastomers: NBR

### Technical data R73G - standard models with diaphragm

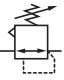
Symbol	Port size	Size	Pressure range (bar)	Adjustment	Weight (kg)	Model
	G1/4	—	0,3 ... 10	Knob	0,48	R73G-2GK-RMN
	G3/8	Basic	0,3 ... 10	Knob	0,48	R73G-3GK-RMN
	G1/2	—	0,3 ... 10	Knob	0,48	R73G-4GK-RMN

### Technical data R73R with diaphragm

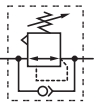
Symbol	Port size	Size	Pressure range (bar)	Adjustment	Weight (kg)	Model
	G1/4	—	0,3 ... 10	Knob	0,48	R73R-2GK-RMN
	G3/8	Basic	0,3 ... 10	Knob	0,48	R73R-3GK-RMN
	G1/2	—	0,3 ... 10	Knob	0,48	R73R-4GK-RMN

### Option selector

Non-return valve		Substitute	R73★-★★★-★★★		Gauge		Substitute
Without (standard)		G			With		G
Integrated		R			Without (standard)		N
Port size		Substitute			Outlet pressure adjustment range *2)		Substitute
1/4"		2			0,3 ... 4 bar		F
3/8"		3			0,3 ... 10 bar (standard)		M
1/2"		4			0,7 ... 17 bar		S
Thread form		Substitute			Diaphragm		Substitute
PTF		A			Relieving (standard)		R
ISO G parallel (standard)		G			Non relieving		N
Adjustment		Substitute					
Knob (standard)		K					
T-bar		T					

\*2) Outlet pressure can be adjusted to pressures in excess of, and less than, those specified. Do not use these units to control pressures outside of the specified ranges.

**Flow characteristics**



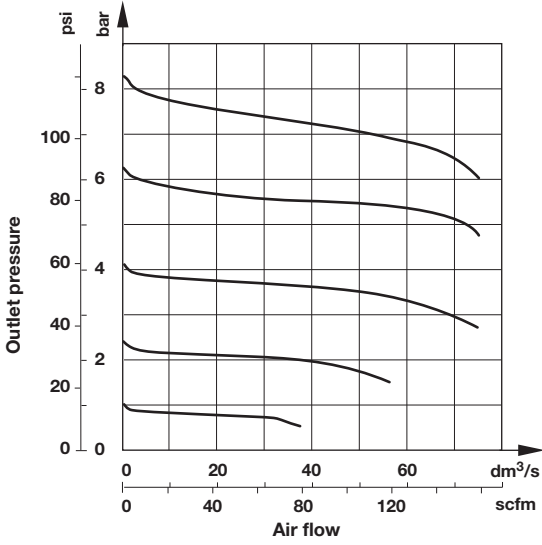



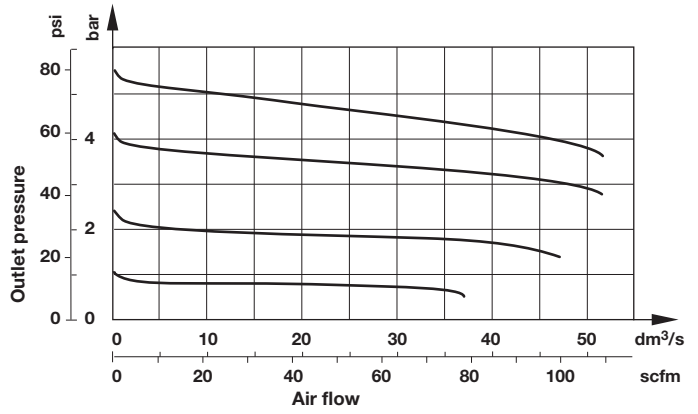

**Inlet pressure: 10 bar (145 psi)**  
**Port size: 3/8"**

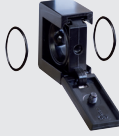
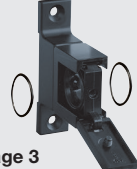

**Inlet pressure: 7 bar (101 psi)**  
**Port size: 3/8"**



**Accessories**

<p><b>Wall mounting bracket</b></p>  <p>Page 4 4424-50</p>	<p><b>Neck mounting bracket</b></p>  <p>Page 4 4461-50</p>	<p><b>Panel nut</b></p>  <p>5191-88</p>	<p><b>Quikclamp®</b></p>  <p>Page 3 4314-51</p>	<p><b>Quikclamp with wall bracket®</b></p>  <p>Page 3 4314-52</p>	<p><b>Tamper resistant kit</b></p>  <p>4455-51</p>
<p><b>Quikmount pipe adaptor *1)</b></p>  <p>Page 3 G1/4: 4315-09 G3/8: 4315-10 G1/2: 4315-11 1/4 PTF: 4315-01 3/8 PTF: 4315-02 1/2 PTF: 4315-03</p>	<p><b>Porting block with three alternative 1/4" ports</b></p>  <p>Page 3 G1/4: 4316-52 1/4 PTF: 4316-50</p>	<p><b>2/2 Shut-off valves (for full technical specification see datasheet 8.180.600)</b></p>  <p>Page 4 G1/4: T73B-2GA-P1N G3/8: T73B-3GA-P1N G1/2: T73B-4GA-P1N 1/4 PTF: T73B-3AA-P1N 3/8 PTF: T73B-2AA-P1N 1/2 PTF: T73B-4AA-P1N</p>	<p><b>3/2 Shut-off valves (for full technical specification see datasheet 8.180.600)</b></p>  <p>Page 4 G1/4: T73T-2GA-P1N G3/8: T73T-3GA-P1N G1/2: T73T-4GA-P1N 1/4 PTF: T73T-3AA-P1N 3/8 PTF: T73T-2AA-P1N 1/2 PTF: T73T-4AA-P1N</p>		

\*1) Please use a Quikmount pipe adaptor if the Quikclamp be mounted at inlet or outlet side.

**Pressure switch**

**Porting block for pressure switch**



Page 3  
0523110000000000

**Pressure switch (0,5 ... 8 bar)**



0881300000000000

**Padlock**

**Padlock (brass) with two keys \*1)**



0613633000000000

**Service kits**

**Service kit**



R73G-KITR

\*1) For shut-off valves and tamper resistant kit

### Gauge

Center back connection, white face  
(for full technical specification see datasheet 8.900.900)



Pressure range bar *1	Mpa	psi	Ø	Thread size	Model
0 ... 6	0 ... 0,6	0 ... 84	50 mm	R1/8	18-015-012
0 ... 10	0 ... 1	0 ... 145	50 mm	R1/8	18-015-013
0 ... 25	0 ... 2,5	0 ... 362	50 mm	R1/8	18-015-014

\*1) primary scale

Center back connection, black face for North America  
(for full technical specification see datasheet 8.900.900)



psig *1	bar	Mpa	Ø	Thread size	Model
0 ... 60	0 ... 4	0 ... 0,4	2" (50 mm)	1/4 NPT	18-015-208
0 ... 160	0 ... 11	0 ... 1,1	2" (50 mm)	1/4 NPT	18-015-209
0 ... 300	0 ... 20	0 ... 2,1	2" (50 mm)	1/4 NPT	18-015-210

\*1) primary scale

### Drawings

Standard

T-bar

Dimensions in mm  
Projection/First angle

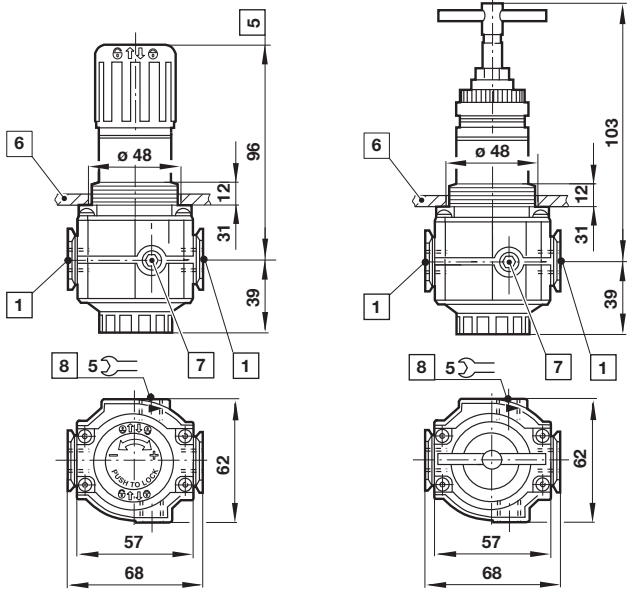

- 1 Main ports 1/4", 3/8" or 1/2"
- 5 Reduces by 4 mm with knob in locked position
- 6 Panel thickness 2 ... 6 mm
- 7 Gauge port Rc1/8 for ISO G and 1/4 PTF for PTF main ports
- 8 Alternative gauge port plugged

### Accessories

#### Quikclamp®

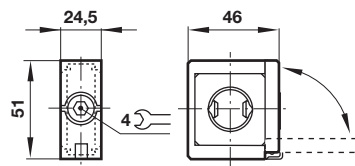

#### Quikclamp® with wall bracket

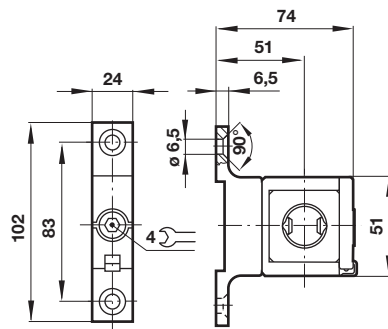

#### Porting block

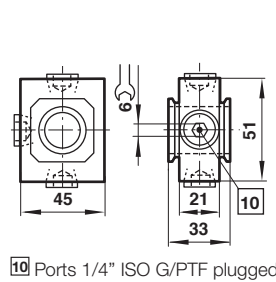

- 10 Ports 1/4" ISO G/PTF plugged

#### Pipe adapter

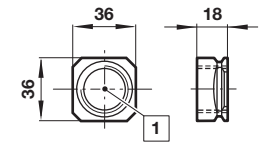

- 1 Main ports 3/8", 1/2" or 3/4" ISO G/PTF

### Wall mounting bracket

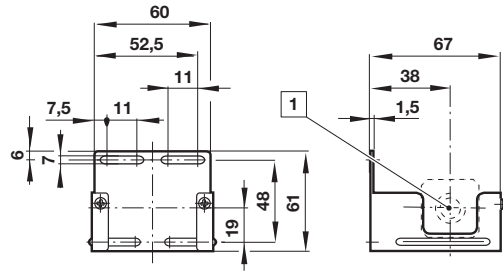

1 Main ports

### Neck mounting bracket

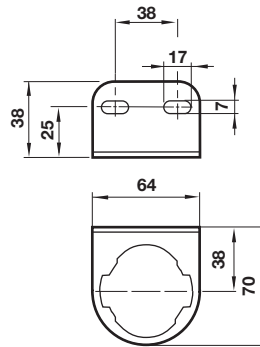

Dimensions in mm  
Projection/First angle



### Shut-off valves

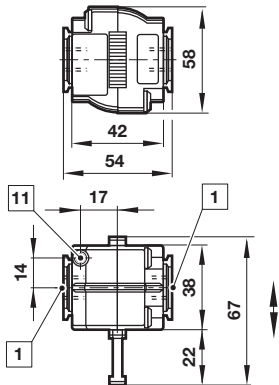

- 1 Main ports 1/4", 3/8" or 1/2" ISO G/PTF
- 12 Exhaust port M5 at 3/2 valve only

### Porting block for pressure switch

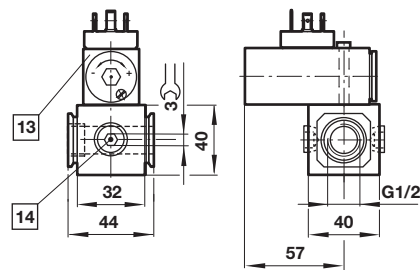

- 13 Pressure switch is not in scope of delivery
- 14 Alternative G1/2 ports plugged

### Warning

These products are intended for use in industrial compressed air systems only. Do not use these products where pressures and temperatures can exceed those listed under

#### »Technical features/data«.

Before using these products with fluids other than those specified, for non-industrial applications, life-support systems or other applications not within published specifications, consult IMI Precision Engineering, Norgren Inc. Through misuse, age, or malfunction, components used in fluid power systems can fail in various modes.

The system designer is warned to consider the failure modes of all component parts used in fluid power systems and to provide adequate safeguards to prevent personal injury or damage to equipment in the event of such failure.

System designers must provide a warning to end users in the system instructional manual if protection against a failure mode cannot be adequately provided.

System designers and end users are cautioned to review specific warnings found in instruction sheets packed and shipped with these products.