

# COILS AND CONNECTORS FOR SERIES 70 AND NAMUR VALVES

## COILS SIDE 22 mm

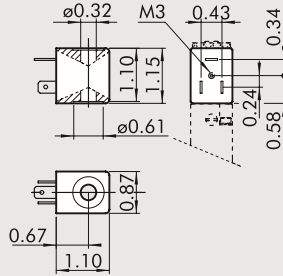

- Voltage tolerance: -10% + 15%
- Insulation class: F155
- Degree of protection: IP65 DIN 40050 with connector
- Avoid prolonged exposure to atmospheric agents
- Coil temperature 100% ED: from 150°F at 68°F – Ambient temperature
- According to Atex 94/9 CE rule, group II, category 3 GD

| Code        | Abbrev.                     | Nominal voltage | Absorption |         |
|-------------|-----------------------------|-----------------|------------|---------|
|             |                             |                 | Inrush     | Holding |
| W0215000151 | Coil 22 Ø 8 BA 2W-12VDC     | 12Vcc           | 2W         | 2W      |
| W0215000101 | Coil 22 Ø 8 BA 2W-24VDC     | 24Vcc           | 2W         | 2W      |
| W0215000111 | Coil 22 Ø 8 BA 3.5VA-24VAC  | 24V 50/60Hz     | 5.3VA      | 3.5VA   |
| W0215000121 | Coil 22 Ø 8 BA 3.5VA-110VAC | 110V 50/60Hz    | 5.3VA      | 3.5VA   |
| W0215000131 | Coil 22 Ø 8 BA 3.5VA-220VAC | 220V 50/60Hz    | 5.3VA      | 3.5VA   |

## "UL" AND "CSA" COILS SIDE 22 mm

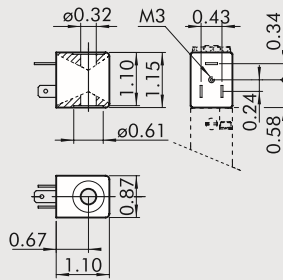

- Voltage tolerance: -10% + 15%
- Insulation class: F155
- Degree of protection: IP65 DIN 40050 with connector
- Avoid prolonged exposure to atmospheric agents
- Coil temperature 100% ED: from 150°F at 68°F – Ambient temperature
- For the standards description look at page 5-4

| Code        | Abbrev.                        | Nominal voltage | Absorption |         |
|-------------|--------------------------------|-----------------|------------|---------|
|             |                                |                 | Inrush     | Holding |
| W0215000251 | Coil 22 Ø 8 BA 2W-12VDC UR     | 12Vcc           | 2W         | 2W      |
| W0215000201 | Coil 22 Ø 8 BA 2W-24VDC UR     | 24Vcc           | 2W         | 2W      |
| W0215000211 | Coil 22 Ø 8 BA 3.5VA-24VAC UR  | 24V 50/60Hz     | 5.3VA      | 3.5VA   |
| W0215000221 | Coil 22 Ø 8 BA 3.5VA-110VAC UR | 110V 50/60Hz    | 5.3VA      | 3.5VA   |
| W0215000231 | Coil 22 Ø 8 BA 3.5VA-220VAC UR | 220V 50/60Hz    | 5.3VA      | 3.5VA   |



## CONNECTORS FOR COIL SIDE mm

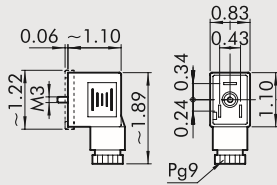

| Code        | Type           | Colour      | Ø Cable |
|-------------|----------------|-------------|---------|
| W0970510011 | Standard       | Black       | PG9     |
| W0970510012 | LED 24V        | Transparent | PG9     |
| W0970510013 | LED 110V       | Transparent | PG9     |
| W0970510014 | LED 220V       | Transparent | PG9     |
| W0970510015 | LED + VDR 24V  | Transparent | PG9     |
| W0970510016 | LED + VDR 110V | Transparent | PG9     |
| W0970510017 | LED + VDR 220V | Transparent | PG9     |
| W0970510070 | Atex II 2 GD   | Black       | PG9     |

## PRE WIRED DIN CONNECTORS 6 FEET CABLE

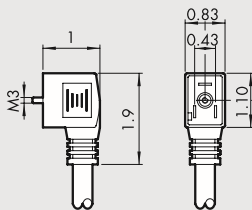

| Code   | Description                  |
|--------|------------------------------|
| 888776 | DIN connector 110VAC led     |
| 888777 | DIN connector standard black |
| 888778 | DIN connector 24VDC          |