

door mounted rotary operator standard NEMA type 1, 3R, 12 with door interlock and door open position accessory for: 3VA6 150/250 3VA5 250

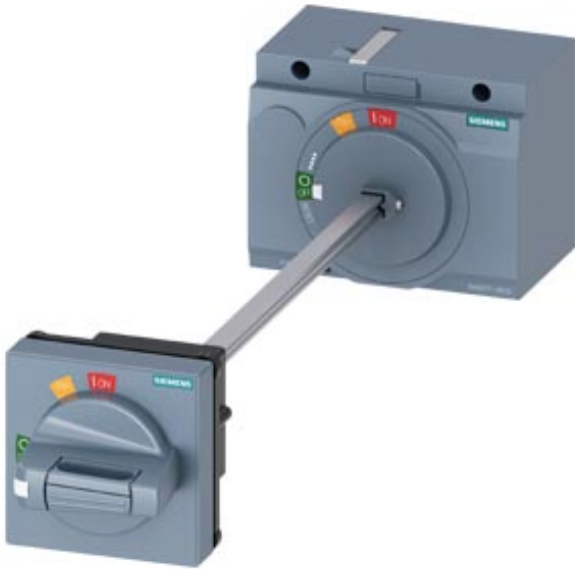

Model	
Product brand name	SENTRON
Product designation	Accessories
Product version	Door-coupling rotary operating mechanism
Accessories	DOOR-COUPLING ROTARY OPERATING MECHANISM

General technical data	
Protection class IP	IP65

Mechanical Design	
Height	82 mm
Width	105 mm
Net weight	648 g

Certificates	
--------------	--

General Product Approval	EMC	Declaration of Conformity
--------------------------	-----	---------------------------



[Miscellaneous](#)



Shipping Approval	other
-------------------	-------



LRS

[Miscellaneous](#)

Further information

Information- and Downloadcenter (Catalogs, Brochures,...)

<http://www.siemens.com/lowvoltage/catalogs>

Industry Mall (Online ordering system)

<https://mall.industry.siemens.com/mall/en/en/Catalog/product?mlfb=3VA9277-0FK31>

Service&Support (Manuals, Certificates, Characteristics, FAQs,...)

<https://support.industry.siemens.com/cs/ww/en/ps/3VA9277-0FK31>

Image database (product images, 2D dimension drawings, 3D models, device circuit diagrams, ...)

http://www.automation.siemens.com/bilddb/cax_en.aspx?mlfb=3VA9277-0FK31

CAX-Online-Generator

<http://www.siemens.com/cax>

Tender specifications

<http://www.siemens.com/specifications>

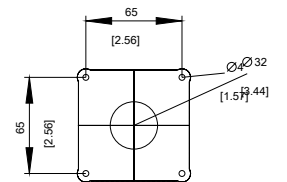
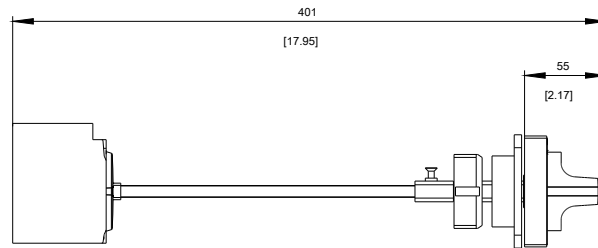
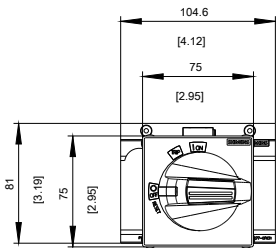

last modified:

01/16/2019