

## AudioLarm II

MW-09-530-Q



### More Information

Warble Tone



[Spec Sheet](#)



[UL Recognized](#)



RoHS Compliant

OUTPUT SOUND and CURRENT CONSUMPTION  
vs. INPUT VOLTAGE PERFORMANCE.

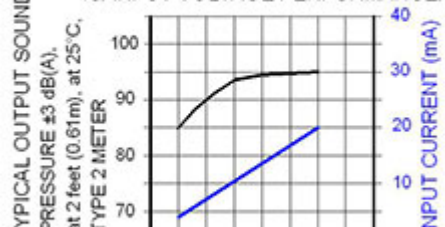

### Specifications

Revision: 7.18

Medium Loud Warble Tone; Moderate Rate; Panel Mount Case and Quick Connect Blades Termination

<b>Mounting:</b>	Panel Mount
<b>Operating Mode:</b>	Medium Loud Moderate Warble Tone
<b>Operating Voltage:</b>	5-30 Vdc
<b>Operating Frequency:</b>	
<b>Typical Operating Current:</b>	2 mA at 5 Vdc 20 mA at 30 Vdc
<b>Typical Sound Pressure:</b>	85±5 dB(A), at 5 Vdc, at 24 inches (61 cm), at 25°C 95±5 dB(A), at 30 Vdc, at 24 inches (61 cm), at 25°C
<b>Termination:</b>	Quick Connect Blades
<b>Termination Strength:</b>	Pull test with a maximum of 22 pounds (10 kg) load
<b>Operating Temperature:</b>	-20_C to +65_C
<b>Storage Temperature:</b>	-40_C to +85_C
<b>Surge Voltage:</b>	20% over maximum rated voltage for less than 5 minutes
<b>Reverse Voltage Protection:</b>	To the maximum operating voltage
<b>Construction Materials:</b>	Internal Circuit- Audio-oscillator and piezoelectric driver Potting- 2 parts epoxy resin or silicone, black Diaphragm- Stainless Steel 304

### Gasket:

**Environmental Durability:** ASTM B117 Certified - Withstands exposure to salt spray for 300 hours  
IP 68 Certified - Withstands water submergence and dust exposure  
Humidity- 95% relative humidity at +40\_C continuously for 100 hours.  
Vibration- Withstands vibration between 0 and 55 Hz. on all axes.

### Life Expectancy:

10 years under normal operating conditions.

### Warranty:

For a period of two years from the date of manufacture under normal operating conditions.

[View Terms and Conditions of Sale](#)

## Dimensions

### REAR

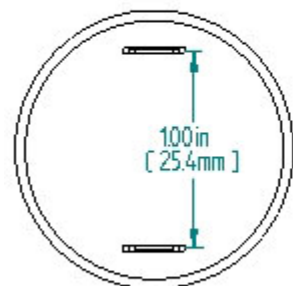

TOLERANCES ARE:  $\pm 0.03$  in.  
[ $\pm 0.76$  mm]

### SIDE

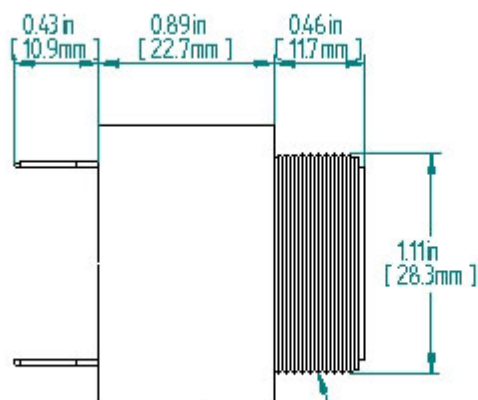

1125-24 UNF THREADS  
FOR REFERENCE ONLY

### RING

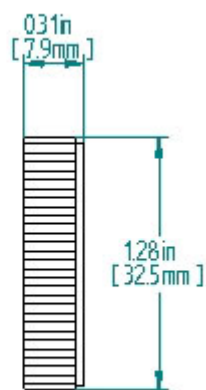

### FRONT

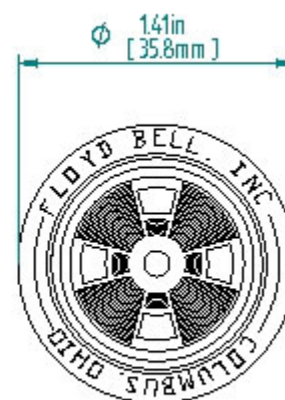

### PANEL MOUNTING



FITS PANELS UP TO  
0.25 in (6.35 mm) THICK

### "Q" TERMINALS

