

EB 80 VALVES

The valves in the EB 80 series are designed to ensure high flow using only one small size valve (14 mm wide), without the need of installing a larger size one, to the benefit of component standardisation. Versions are available with all the main air supply diagrams - from 2/2 to 5/3. The valves are secured to the base with two sturdy M4 captive screws. They come with all the accessories that facilitate their use: manual control, monostable or bistable, LED light, plate with air supply diagram and technical data, white plates available to the customer. This family also includes a dummy valve that is used to plug unused positions of the base, and a bypass element to enhance relief and supply or to create special compressed air circuits.



TECHNICAL DATA								
Operating pressure	Non-assisted valves	bar	5/2 and 5/3		2/2 and 3/2			
			3 to 8		3.5 to 8			
			MPa		0.3 to 0.8		0.35 to 0.8	
Assisted valves		psi	43 to 116		51 to 116			
			bar		Vacuum to 10			
			MPa		Vacuum to 1			
Servo pressure		psi	Vacuum to 145					
			bar	3 to 8		min. (see graph on page 1-131) / max. 8		
				MPa		0.3 to 0.8		min. (see graph on page 1-131) / max. 0.8
Ambient temperature		°C	to to		min. (see graph on page 1-131) / max. 116			
			°F		-10 to 50 (at 116 psi)			
					14 to 122 (at 116 psi)			
Flow rate at 91 psi ΔP 14.5 psi			Ø 4 mm (5/32") **	Ø 6 mm**	Ø 8 mm (5/16") **	Ø 1/4" **		
			valve 2/2	scfm	12.4	15.2	17.7	15.2
			valve 3/2	scfm	12.4	21.2	24.8	21.2
			valve 5/2	scfm	12.4	23.0	28.3	23.0
			valve 5/3	scfm	12.4	16.3	17.7	16.3
Actuation response time (TRA) / reset response time (TRR) at 6 bar			TRA/TRR valves 2/2 and 3/2		ms			
			TRA/TRR valves 5/2 monostable		ms			
			TRA/TRR valve 5/2 bistable		ms			
			TRA/TRR valve 5/3		ms			
Fluid			Unlubricated air					
			ISO 8573-1 class 4-7-3					
Air quality required			From 10.8 to 31.2 (12V+/- 10% and 24 V +/- 30%)					
Supply voltage	V		N.B.: This voltage must be available at the valve.					
Power for each valve	W		Refer on page 1-109 to check any load loss along the cables and bases					
			3 for a few milliseconds. Holding 0.3					
Drive			PNP or NPN					
Solenoid rating			100% ED					
Versions			Manual monostable or bistable control. Various compressed air diagrams					
Degree of protection			IP65					

IMPORTANT! Voltage greater than 32VDC will damage the system irreparably.

** Ø of the cartridge on the base.

COMPONENTS

- ① BODY: technopolymer
- ② CONTROL: technopolymer
- ③ BASE: technopolymer
- ④ SOLENOID PILOT
- ⑤ DISPLAY: LED light and optical tester in technopolymer
- ⑥ TAG: removable
- ⑦ MANUAL CONTROL 14, FOR PORT 4: monostable or bistable, in brass
- ⑧ MANUAL CONTROL 12, FOR PORT 2: monostable or bistable, in brass
- ⑨ SCREW FOR FIXING TO THE BASE: M4 with PH 1 cross-head, galvanised steel (Tightening torque: 0.74 lbf ft).
- ⑩ TAG: technopolymer with laser-etched wording

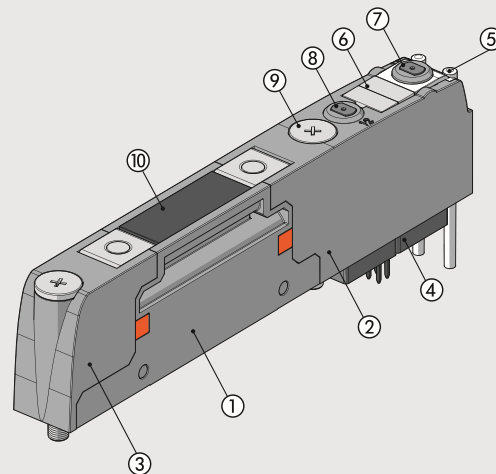
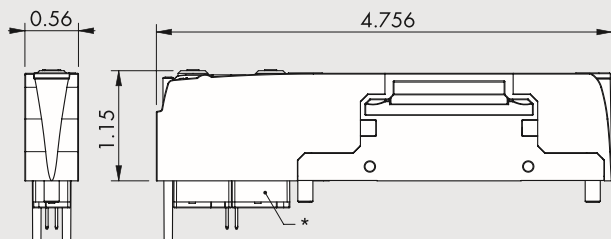
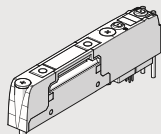

DIMENSIONS - ORDERING CODES
EB 80 VALVE

* The second solenoid pilot is not present in the valves V= 5/2 monostable.

N.B.: The valves Z, I, W, L, K, O can be mounted only on bases having 6 or 8 controls.

SERVO MINIMUM PRESSURE FOR VALVES 2/2 AND 3/2

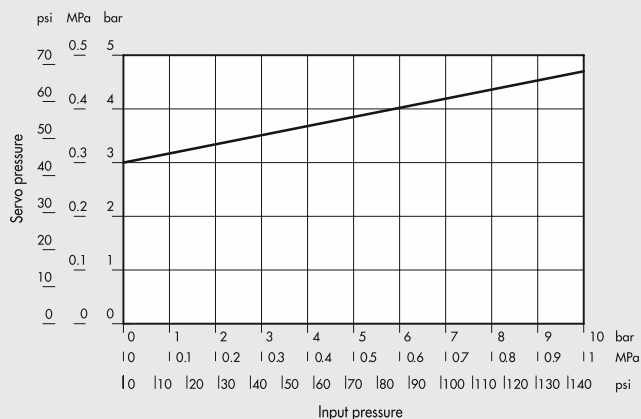
If the island is configured without servo, minimum pressure 3.5 bar



Symbol	Type	Code	Manual control	Weight [lb]
	2 valves 2/2 NC	708203Z0	monostable	0.18
		708203Z1	bistable	0.18
	2 valves 3/2 NC	708203I0	monostable	0.18
		708203I1	bistable	0.18
valid as 5/3 OC				
	2 valves 3/2 NO	708203W0	monostable	0.18
		708203W1	bistable	0.18
valid as 5/3 PC				
	3/2 NC + 3/2 NO	708203L0	monostable	0.18
		708203L1	bistable	0.18
	monostable 5/2	708203V0	monostable	0.152
		708203V1	bistable	0.152
	bistable 5/2	708203K0	monostable	0.178
		708203K1	bistable	0.178
	5/3 CC	708203O0	monostable	0.18
		708203O1	bistable	0.18

DUMMY VALVE (PLUG)

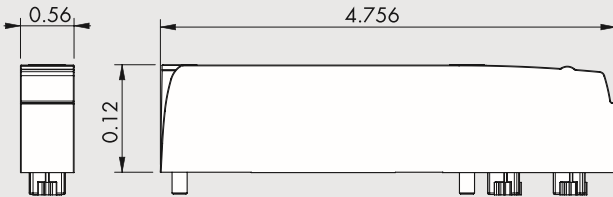
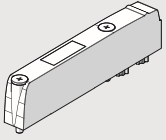

Symbol	Description	Code	Weight [lb]
N	Dummy valve	708203N0	0.1

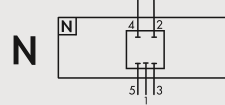

BYPASS

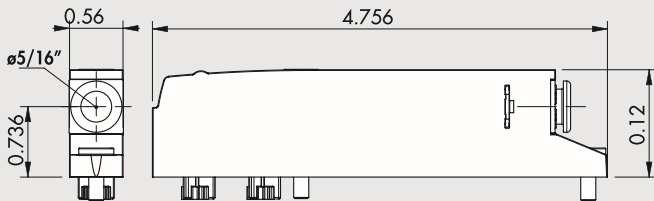
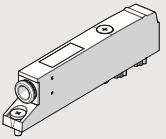

Symbol	Description	Code	Weight [lb]
Y	Bypass Ø 8	708203Y8	0.11

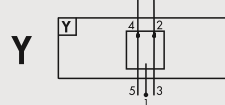

N.B.: Maximum pressure in the ports 2 and 4:
8 bar - 116 psi

Connects port 3 of the base to port 2 and port 5 to port 4.
The fitting present is connected to port 1.

KEY TO CODES

7082	03	V	0
FAMILY	TYPE	SCHEMA	MANUAL CONTROL
7082 EB 80	03 Electric, servo-assisted	Z 2 valves 2/2NC I 2 valves 3/2 NC W 2 valves 3/2 NO L 3/2 NC + 3/2 NO V 5/2 monostable K 5/2 bistable O 5/3 CC N Dummy valve (plug) Y Bypass	0 Monostable or for dummy valve 1 Bistable 8 For bypass only

