

# Datasheet

## Clear Filament Indicator Lamp

RS Stock number [339-3434](#)

Dimensions: (mm)

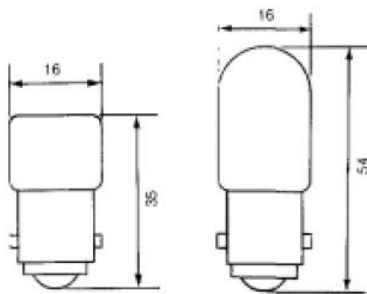

RERATED M.S.C.P. =  $\left(\frac{V}{V_i}\right)^{3.5}$  M.S.C.P. AT DESIGN VOLTS

RERATED LIFE =  $\left(\frac{V_i}{V}\right)^{12}$  LIFE AT DESIGN VOLTS

RERATED CURRENT =  $\left(\frac{V}{V_i}\right)^{.55}$

V = APPLICATION VOLTAGE  
 V<sub>i</sub> = DESIGN VOLTAGE

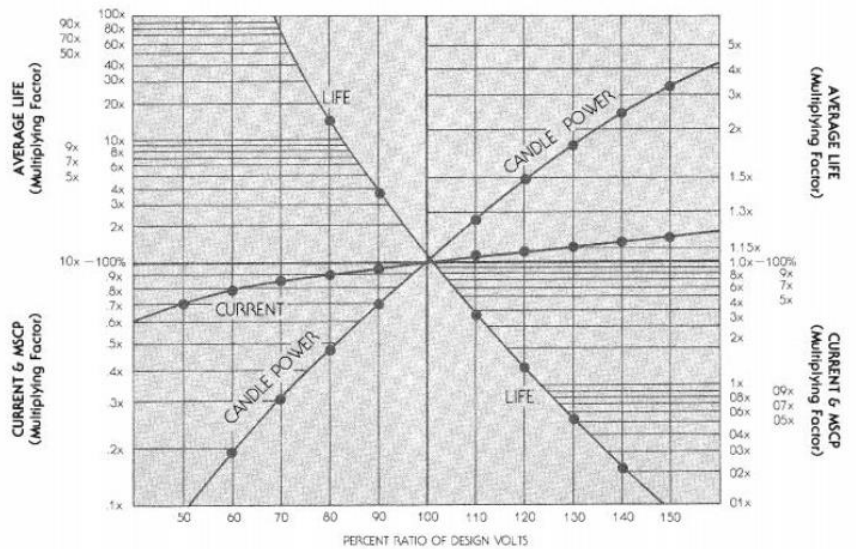

### Specifications

- Life: Average life hours are based on rated voltage, 6 cycle alternating current in a room temperature ambient environment, under static conditions.
- Converting Brightness: Mean Spherical Candle Power (MSCP) is convertible to lumens, its metric equivalent, by a factor of 4π. That is MSCP x 4π (approx. 12.6) = lumens.