

Cover plates for panel cutouts

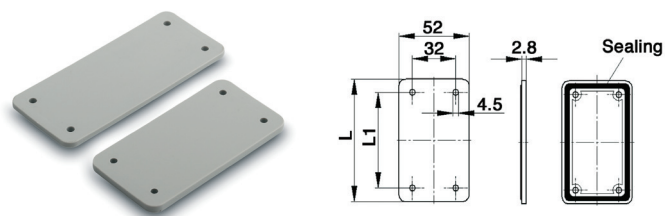

Part number	Size	Dimensions (mm)	
		L	L1
10018920	HB 6	90.5	70.0
10018921	HB 10	103.0	83.3
10018922	HB 16	123.5	103.0
10018923	HB 24	150.0	130.0

Plates do not include mounting screws

Adapters for D-sub connectors

Single D-sub connectors

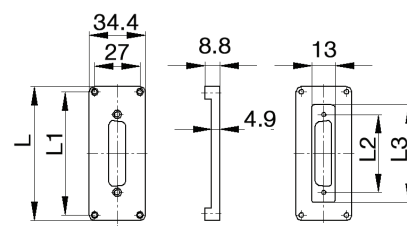

Part number	Size	DB cutout	L	Dimensions (mm)		
				L1	L2	L3
11764200	HB 6	DB 9	51.3	44.0	25.0	31.4
11764202	HB 6	DB 15	51.3	44.0	33.3	39.2

Part number	Size	DB cutout	L	Dimensions (mm)		
				L1	L2	L3
11764300	HB 10	DB 25	64.2	57.0	47.1	53.1
11764400	HB 16	DB 25	85.0	77.5	47.1	53.6

Includes mounting screws

Double D-sub connectors

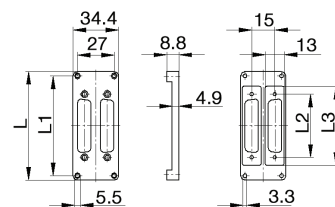

Part number	Size	DB cutout	L	Dimensions (mm)		
				L1	L2	L3
11764201	HB 6	DB 9 (x2)	51.3	44.0	25.0	31.4
11764203	HB 6	DB 15 (x2)	51.3	44.0	33.3	39.2

Part number	Size	DB cutout	L	Dimensions (mm)		
				L1	L2	L3
11764301	HB 10	DB 25 (x2)	64.2	57.0	47.1	53.1
11764401	HB 16	DB 25 (x2)	85.0	77.5	47.1	53.6

Includes mounting screws

If not otherwise specified, all values relating to the product are nominal values. Photographs are not to scale and are not true representations of the products in question.