

NJ MIN SERIES

- Durable – rugged aluminum body construction
- Strong hold – powerful vacuum up to 27"Hg [914mbar]
- Fast response – mounts in-line, close to vacuum point - no delay due to long plumbing lines
- Efficient – minimal air consumption, provides instantaneous vacuum as needed
- Safe operation – no electricity needed
- Reliable operation – straight-through design with no moving parts

Technical Data

Fluid

Filtered (50 Micron) unlubricated, non-corrosive dry gasses

Operating Pressure

80 PSI (5.5 bar) Standard or 60 PSI (4.1 bar)

Operating Temperature

-100° to 400° F (-73° to ~204°C)

Materials

Pump Body: Anodized Aluminum

Silencer Body: Brass

Supply / Vacuum Line

Min. 5/32" OD (4mm), 1/4" OD (6mm) tube preferred for lines exceeding 3' (1M)



Standard Models





Part Number	Max. Vacuum Level	Max. Vacuum Flow	Air Consumption	Accessories	Material
NJS-40UM-S32M01	27" Hg	0.23 SCFM	0.52 SCFM	NVCF2-1032M Silencer	Aluminum

Option selector

Series		Substitute	Materials		Substitute
NJS	Imperial Thread 27"Hg [914mbar]	NJS	Aluminum (Standard)		M01
NJSM	Metric Thread 27"Hg [914mbar]	NJSM	303 Stainless Steel		M05
			304 Stainless Steel		M06
			316 Stainless Steel		M07
			PVC		M09
			Delrin (Black)		M10
			Delrin (White)		M11
			PEEK		M14
Vacuum Flow Level		Substitute	Silencers		Substitute
	Venturi Cartridge 40 @ 80 PSI (Standard)	40UM	None (Standard)		S00
	Venturi Cartridge 40 @ 60 PSI	4XUM	NVCF2-1032M		S32

NJS★-40★★-S★★M★★

Accessories

Standard Models	Silencer	Inline Fitting	Swivel Elbow Fitting	Vacuum Fitting	Flat Cup	Spring Leveler
						
NJS-40UM-S32M01	NVCF2 Silencer	124250410	124470410	VCF3-1032M	VCR-F***-*	NVSL1-*
NJS-40UM-S32M05	NVCF2 Silencer	124250410	124470410	VCF3-1032M	VCR-F***-*	NVSL1-*

● Dimensions inches (mm)

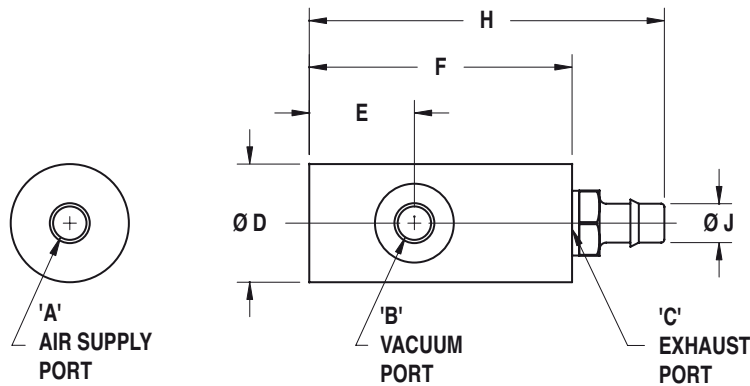

Model	Units	A	B	C	D	E	F	H	J
NJS-40UM-S00M01	Imperial	10-32F	10-32F	10-32F	0.56	0.45	1.45	N/A	N/A
NJS-40UM-S32M01	Imperial	10-32F	10-32F	10-32F	0.56	0.45	1.45	1.90	0.19
NJSM-40UM-S00M01	(Metric)	(M5)	(M5)	(M5)	(14.30)	(11.40)	(36.80)	-	-
NJSM-40UM-S32M01	(Metric)	(M5)	(M5)	(M5)	(14.30)	(11.40)	(36.80)	(48.30)	(4.70)

● Performance Data

Model	Air Consumption SCFM (L/min)	Vacuum Level "Hg (mbar)	0"Hg (0)	3"Hg (102)	6"Hg (203)	9"Hg (305)	10"Hg (339)	12"Hg (406)	15"Hg (508)	18"Hg (609)	20"Hg (677)	21"Hg (711)	24"Hg (813)	27"Hg (914)
NJS-40UM	0.52 (14.70)	Vacuum Flow SCFM (L/min)	0.23 (6.50)	0.20 (5.70)	0.17 (4.80)	0.15 (4.20)	- (-)	0.13 (3.70)	0.10 (2.80)	0.08 (2.30)	- (-)	0.05 (1.40)	0.03 (0.80)	0 (0)
		Evacuation time (seconds)	0 (0)	24.80 (0.90)	54.40 (1.90)	89.50 (3.20)	- (-)	130.30 (4.60)	178.30 (6.30)	240.40 (8.50)	- (-)	334.50 (11.80)	516.70 (18.20)	1028 (36.30)

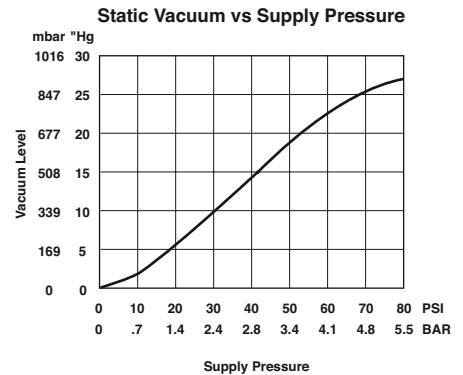
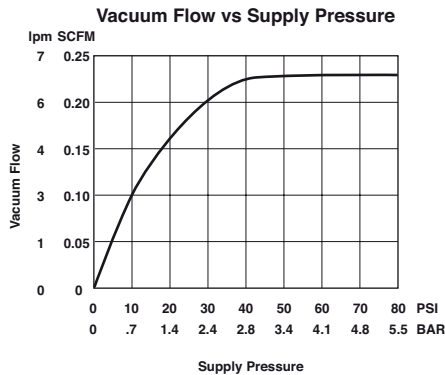
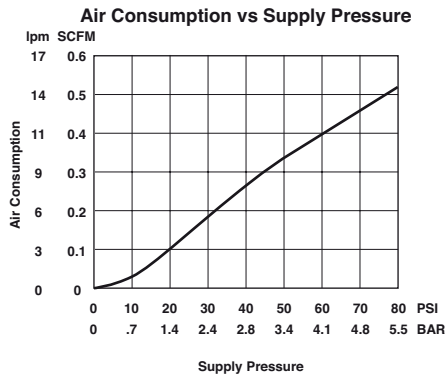

Warnings

Improper selection, misuse, age or malfunction of components used in systems can cause failure in various modes. The system designer is warned to consider the failure modes of all component parts and to provide adequate safeguards to prevent personal injury or damage to equipment or property in the event of such failure modes. System designers and end users are cautioned to consult instruction sheets and specifications available from the factory. The system designer/end user is responsible for verifying that all requirements for the application are met.

Warranty

The products described herein are warranted subject to seller's Standard Terms and Condition of Sale, available at seller's website.