

# Data sheet Illuminated pushbutton Ø 22 mm stainless steel 316L.

*Part No.: 82-6651.1134*

## Technical data



Front form	round
Mounting cut-out	Ø 22.3 mm
Terminal	Plug-in terminal
Shape of illumination	Ring (Tritan)
Operating voltage	24 V DC (LED)
Lens illumination	illuminative
Lens colour	Silver
Lens shape	flush
Lens material	Stainless steel 316L
Lens optics	opaque
Front bezel shape	flush
Front bezel material	Stainless steel 316L
Weight	0.018 kg
IP front protection	IP65, IP67
Contacts change over	1 C
Contact material	Silver
Illumination colour	Green
Kind of illumination	Single-LED
Switching action	Momentary
Switching voltage	36 V
Switching voltage kind of	AC/DC
Switching current	0.6 A
Switching system	Snap-action switching element

### Hints

- Switching voltage: max. 36 V AC/1A, max. 36 V DC/0.6

## Dimensions

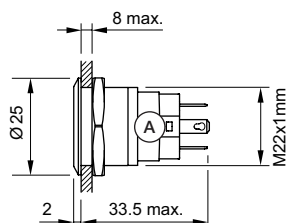

## Mounting cut-outs

---

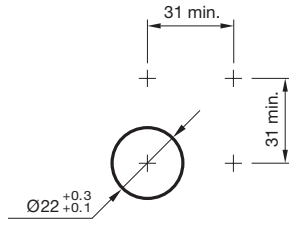

## Wiring diagrams

---

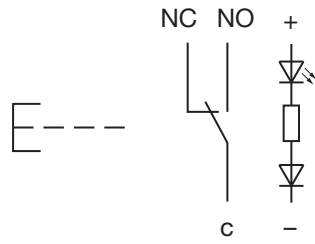

## Component layouts

---

