

| | | |
|---------------------------|-------------------------------|---|
| 52115700 | DATA SHEET |  |
| Valid from: 03.07.2018 | SKINTOP® MS-XL/ MSR-XL | |

The SKINTOP® MS-XL / MSR-XL a nickel-plated brass cable gland with long connecting thread which combines high quality with regard to consistency and reliability.
This gland is especially designed for use in manufacturing of machines and equipment, in measuring, controlling as well as in the pharmaceutical industry and for medical equipment.



Components:

| | |
|---------------------------|----------------------|
| Gland body | Brass, nickel-plated |
| Cap nut | Brass, nickel-plated |
| Insert with lamellar cage | Polyamide |
| Sealing ring | CR |
| O-ring | NBR |

Technical features:

| | |
|-------------------|---|
| Connecting thread | PG7 up to PG29 acc. to DIN 40430 |
| Protection class | IP68 - 5 bar, test acc. to EN 60529 |
| Temperature range | Dynamic -25 °C up to +100 °C Statically -40 °C up to +100 °C |
| Design | MS-XL standard MSR-XL with reducing sealing ring |

Norm references:



| | | |
|--|---------------------------------------|-------------|
| Creator: V.Charcenko /PDP Released: DAMU1/PDP | Document: DB52115700EN Version: 03 | Page 1 of 2 |
|--|---------------------------------------|-------------|

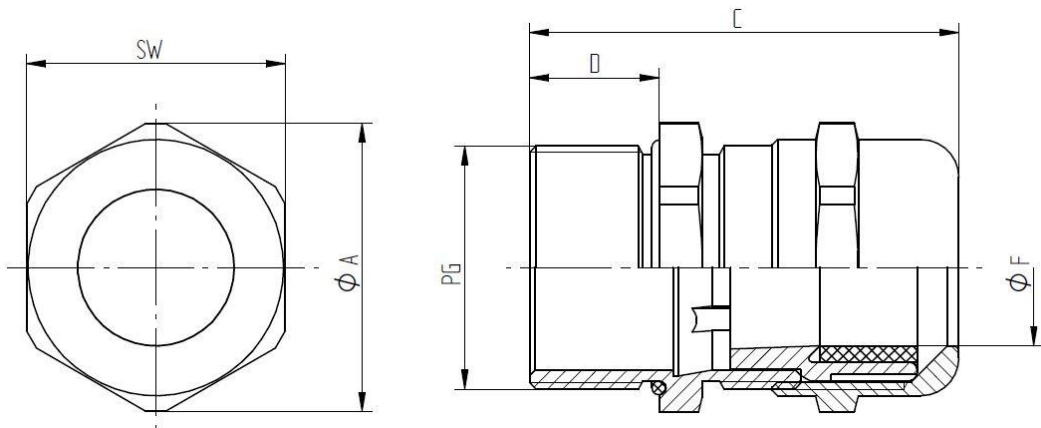

SKINTOP® MS-XL

| PG | SW [mm] | Ø A [mm] | C [mm] | | D [mm] | Ø F [mm] Clamping range | Article No. |
|--------|---------|----------|--------|------|--------|----------------------------|-------------|
| | | | min. | max. | | | |
| PG7 | 14 | 15,5 | 27 | 32 | 12 | 2 - 6,5 | 5211 5700 |
| PG9 | 17 | 18,9 | 29,5 | 35 | 12 | 4 - 8 | 5211 5710 |
| PG11 | 20 | 22,2 | 31,5 | 38 | 12 | 4 - 10 | 5211 5720 |
| PG13,5 | 22 | 24,4 | 31,5 | 39,5 | 12 | 5 - 12 | 5211 5730 |
| PG16 | 24 | 26,7 | 33,3 | 40,5 | 12 | 8 - 14 | 5211 5740 |
| PG21 | 30 | 33,5 | 36,5 | 45 | 12 | 11 - 18 | 5211 5750 |
| PG29 | 40 | 43,5 | 41,2 | 52 | 15 | 16 - 25 | 5211 5760 |

SKINTOP® MSR-XL

| PG | SW [mm] | Ø A [mm] | C [mm] | | D [mm] | Ø F [mm] Clamping range | Article No. |
|--------|---------|----------|--------|------|--------|----------------------------|-------------|
| | | | min. | max. | | | |
| PG7 | 14 | 15,5 | 27 | 32 | 12 | 2 - 5 | 5211 5770 |
| PG9 | 17 | 18,9 | 29,5 | 35 | 12 | 2 - 6 | 5211 5780 |
| PG11 | 20 | 22,2 | 31,5 | 38 | 12 | 3 - 7 | 5211 5790 |
| PG13,5 | 22 | 24,4 | 31,5 | 39,5 | 12 | 4 - 9 | 5211 5800 |
| PG16 | 24 | 26,7 | 33,3 | 40,5 | 12 | 6 - 13 | 5211 5810 |
| PG21 | 30 | 33,5 | 36,5 | 45 | 12 | 8 - 16 | 5211 5820 |
| PG29 | 40 | 43,5 | 41,2 | 52 | 15 | 10,5 - 20 | 5211 5830 |

For more information please see our current catalogue. Please do not hesitate to contact our laboratory if there are any questions regarding resistance against aggressive agents and special oil.