



ENGLISH

Datasheet

# RS Pro 12 bar Iron Inverted Bucket Steam Trap, ½" BSP

RS Stock No: 720-9254



## Product Description

These RS Pro inverted bucket steam traps are recommended for all services where the most important requirements are overall operating efficiency and long, trouble-free service life.

They operate intermittently, either wide open or tightly closed and are therefore best suited for service at medium and high steam pressures.

Connections are female screwed for horizontal installation.

USE:	Saturated and superheated steam.
SIZES:	½"
CONNECTIONS:	Female screwed ISO 7/1Rp(BS21).
INSTALLATION:	Horizontal installation

PMO – Max. operating pressure:	12 bar
TMO – Max. operating temperature:	150 °C
PMA – Max. allowable pressure:	16 bar

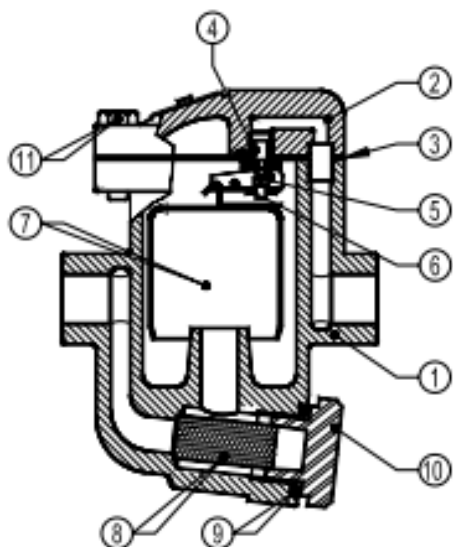

Pos. Num.	Designation	Material
1	Body	GJS-400-15 / 0.7040
2	Cover	GJS-400-15 / 0.7040
3	*Gasket	Stainless St. / Graphite
4	*Seat	AISI 410 / 1.4006
5	*Valve	AISI 410 / 1.4006
6	*Lever	AISI 304 / 1.4301
7	*Bucket	AISI 304 / 1.4301
8	*Strainer Screen	AISI 304 / 1.4301
9	Gasket	Stainless St. / Graphite
10	Plug	A105 / 1.0432
11	Bolts	Steel 8.8
*Available spare parts		

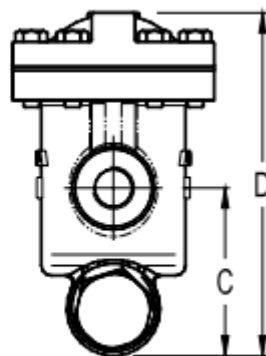
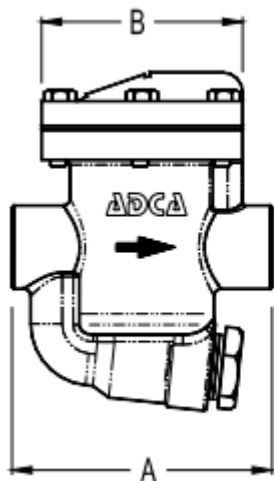

ENGLISH

### Dimensions (MM)

SIZE	A	B	C	D	WGT. Kgs
1/2"	130	102	85	170	3.9