

7 MINIRAIL Product Overview

7.2.10 Dimension Tables, Load Capacities and Moment Loads for Standard Sized MINIRAIL

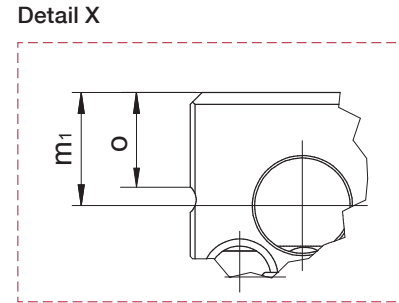
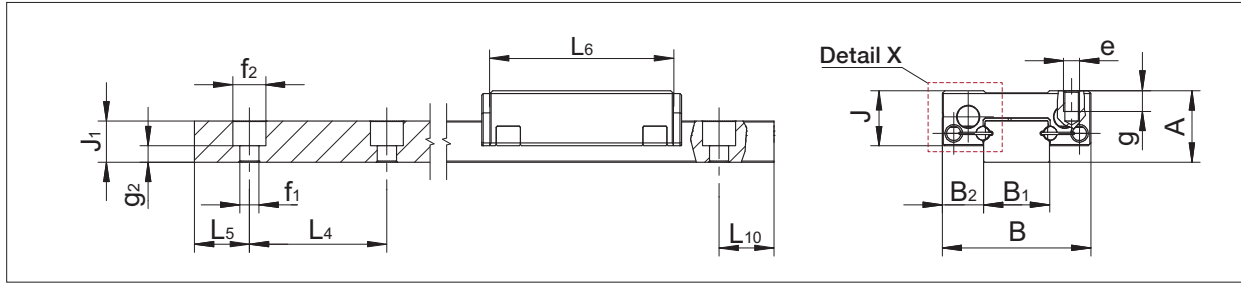

Name		Standard size 7				Standard size 9					
		Guideway	MNNS	MNN	MNNL	MNNXL	Guideway	MNNS	MNN	MNNL	MNNXL
Dimensions (mm)	A	8				10					
	B	17				20					
	B ₁	7				9					
	B ₂	5				5.5					
	J	6.5				8					
	J ₁	4.5				5.5					
	L		18.6	24.6	32.1	41.1		22	32	40	50
	L ₁		-	8	13	20		-	10	16	26
	L ₂		-	-	-	10		-	-	-	13
	L ₄	15				20					
	L ₅ /L ₁₀	5				7.5					
	L ₆		16.1	22.1	29.6	38.6		19	29	37	47
	N		12					15			
	e		M2					M3			
	f ₁	2.4				3.5					
	f ₂	4.2				6					
	g		2.5					3			
g ₂	2.2				2						
m ₁		3.1					3.8				
o		2.5					3.1				
Load capacity (N)	C ₀	935	1560	2340	3275	1385	2770	3880	5270		
	C	645	925	1230	1550	1040	1690	2140	2645		
Torque (Nm)	M ₀₀	3.4	5.6	8.4	11.8	6.5	12.9	18.1	24.5		
	M _{0L}	1.6	4.3	9.3	18	2.8	10.2	19.4	35.1		
	M ₀	2.3	3.3	4.4	5.6	4.8	7.9	9.9	12.3		
	M _L	1.1	2.5	4.9	8.5	2.1	6.2	10.7	17.6		
Weights guideway (g/m), carriage (g)		216	9	13	18	23	309	16	24	31	40

7 MINIRAIL Product Overview

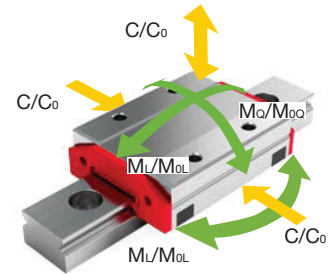
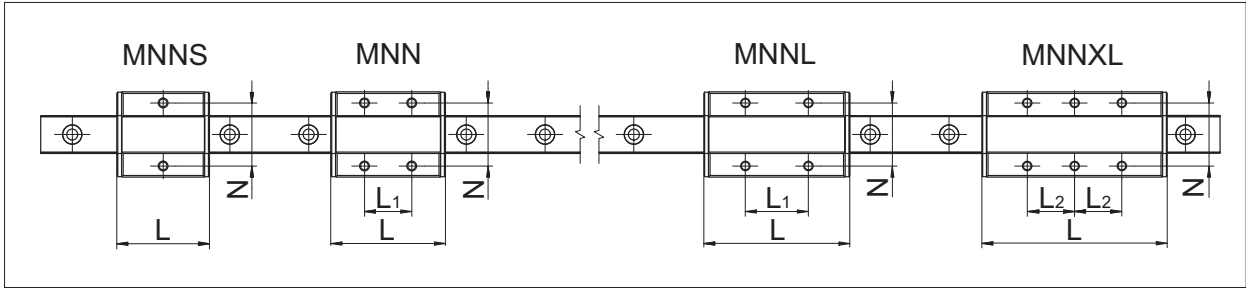

		Name	Standard size 12				Standard size 15					
			Guideway	MNNS	MNN	MNNL	MNNXL	Guideway	MNNS	MNN	MNNL	MNNXL
Dimensions (mm)	A	System height	13				16					
	B	System width	27				32					
	B ₁	Rail width	12					15				
	B ₂	Distance between reference surfaces	7.5				8.5					
	J	Carriage height	10				12					
	J ₁	Rail height	7.5					9.5				
	L	Carriage length with wipers		23.9	36.4	46.4	58.9		31.7	43.7	58.7	73.7
	L ₁	Longitudinal spacing of attachment holes		-	15	20	30		-	20	25	40
	L ₂	Longitudinal spacing of attachment holes		-	-	-	15		-	-	-	20
	L ₄	Spacing of attachment holes	25					40				
	L ₅ /L ₁₀	Position of first and last attachment hole	10					15				
	L ₆	Carriage length (steel body)		20.9	33.4	43.4	55.9		28.7	40.7	55.7	70.7
	N	Lateral attachment hole spacing		20					25			
	e	Thread		M3					M3			
	f ₁	Hole diameter	3.5					3.5				
	f ₂	Countersink diameter	6					6				
	g	Thread depth		3.5					4			
g ₂	Step drilling height	3					5					
m ₁	Position of lubrication holes		4.75					5.55				
o	Reference face height		3.9					4.9				
Load capacity (N)	C ₀	Static load capacity	1735	3900	5630	7800	3120	5620	8740	11855		
	C	Dynamic load capacity	1420	2510	3240	4070	2435	3680	5000	6200		
Torque (Nm)	M _{0L}	Permissible lateral static torque	10.6	23.8	34.4	47.6	23.7	42.7	66.4	90.1		
	M _{0L}	Permissible longitudinal static torque	3.6	16.3	32.9	61.8	9.4	28.1	65.5	118.6		
	M ₀	Permissible lateral dynamic torque	8.7	15.3	19.8	24.8	18.5	27.9	38.1	47.1		
	M _L	Permissible longitudinal dynamic torque	3	10.4	18.9	32.2	7.3	18.4	37.6	62		
Weights guideway (g/m), carriage (g)			598	29	47	63	81	996	56	81	114	146