



stand-alone assembly support for
 3RU21/3RB30/3RB31/3RR2 Size S2 Stand-alone
 installation Main circuit: Screw

General technical data

Product brand name		SIRIUS
Product designation		individual mount
Size of overload relay		S2
Ambient temperature		
• during storage	°C	-50 ... +80
• during operation	°C	-20 ... +70

Installation/ mounting/ dimensions

Mounting type		screw and snap-on mounting onto 35 mm standard mounting rail
Width	mm	55
Height	mm	105
Depth	mm	110

Connections/ Terminals

Type of electrical connection		screw-type terminals
• for main current circuit		
•		

— Type of connectable conductor cross-sections for main contacts finely stranded
 — with core end processing

- Type of connectable conductor cross-sections at AWG conductors
 — for main contacts

	1x (1 ... 35 mm ²)
	1x (18 ... 1)

Certificates/ approvals

General Product Approval	Declaration of Conformity
--------------------------	---------------------------



[Miscellaneous](#)

Test Certificates	Shipping Approval
-------------------	-------------------

[Type Test Certificates/Test Report](#)

[Special Test Certificate](#)



Shipping Approval	other
-------------------	-------



[Confirmation](#)

Further information

Information- and Downloadcenter (Catalogs, Brochures,...)

<https://www.siemens.com/ic10>

Industry Mall (Online ordering system)

<https://mall.industry.siemens.com/mall/en/en/Catalog/product?mlfb=3RU2936-3AA01>

Cax online generator

<http://support.automation.siemens.com/WW/CAXorder/default.aspx?lang=en&mlfb=3RU2936-3AA01>

Service&Support (Manuals, Certificates, Characteristics, FAQs,...)

<https://support.industry.siemens.com/cs/ww/en/ps/3RU2936-3AA01>

Image database (product images, 2D dimension drawings, 3D models, device circuit diagrams, EPLAN macros, ...)

http://www.automation.siemens.com/bilddb/cax_de.aspx?mlfb=3RU2936-3AA01&lang=en

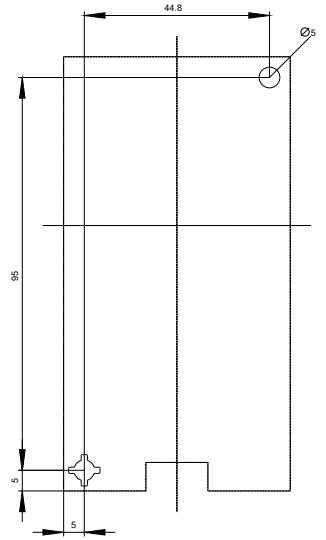
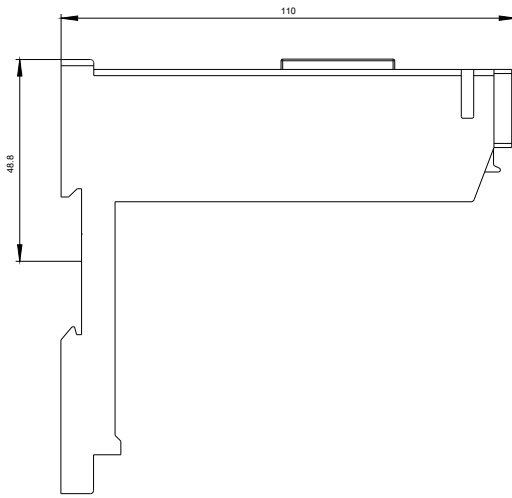
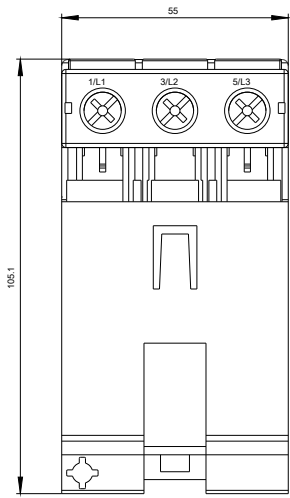

1/L1

3/L2

5/L3

last modified:

03/09/2020