

THIS DOCUMENT IS SUBJECT TO CHANGE WITHOUT NOTICE. IT IS CONFIDENTIAL AND A PROPERTY OF Amphenol LTW. DISCLOSURE TO THIRD PARTY HAS TO BE AUTHORIZED BY Amphenol LTW.

REV.	ECN NO.	DATE	SIGN	DESCRIPTION
F	LEN1750030~41	2017/04/25	Lingpeng	Add 5Pin
G	LEN1790175~90	2017-08-29	Lingpeng	Update The Note
H	NI80019	2019-03-14	Peng	Add All Seals Product

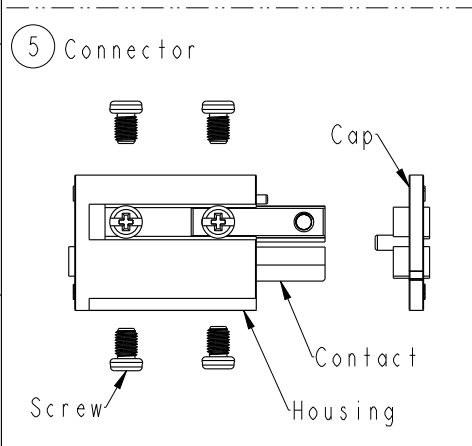

**ALTW**  
**CONFIDENTIAL**  
 2019-03-14  
**R&D DEPT.**

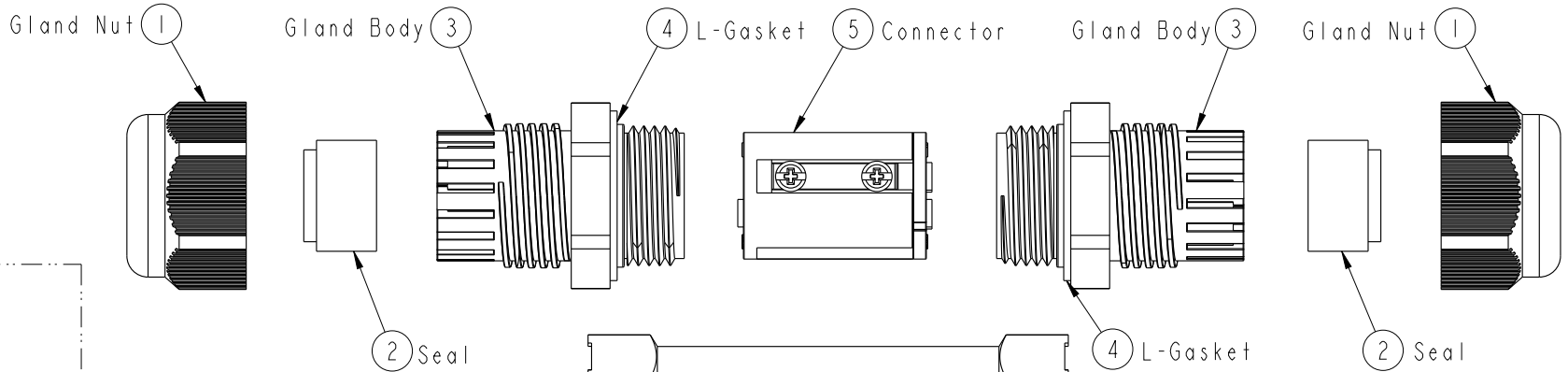
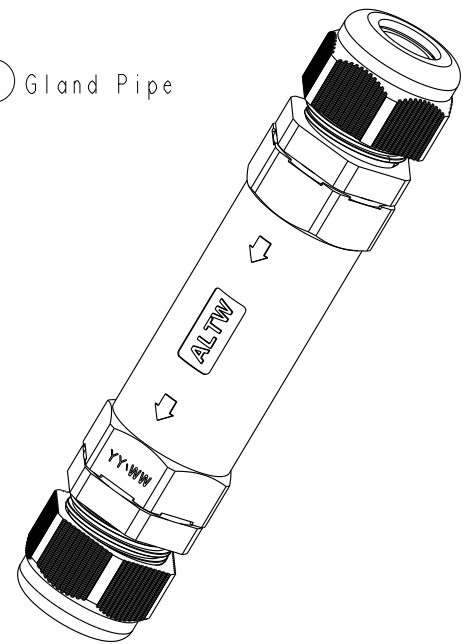
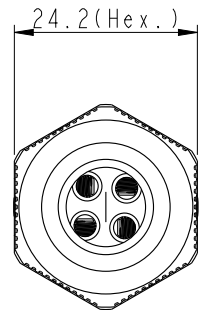
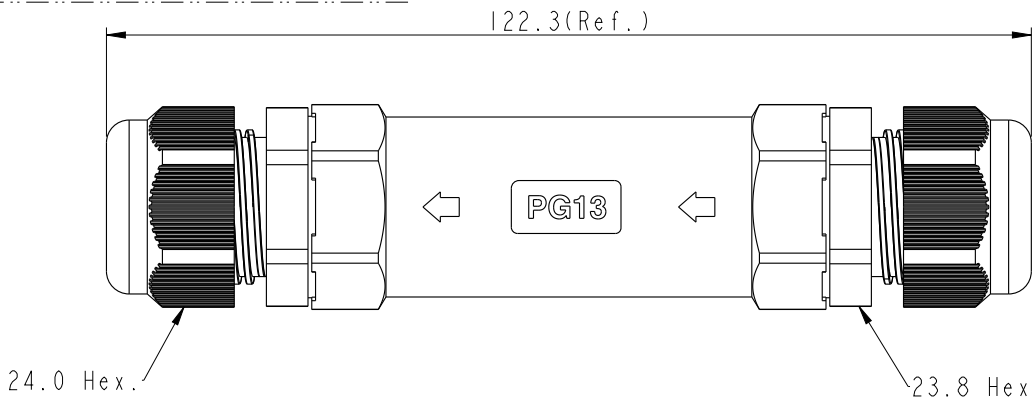
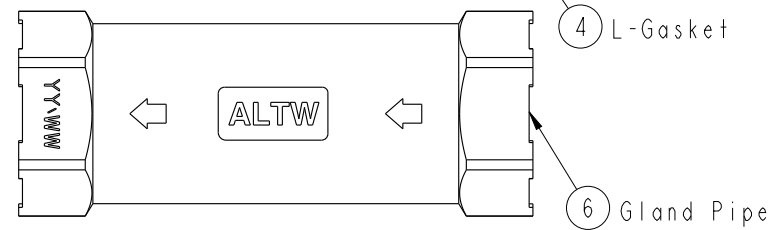

UNIT:mm	
TOLERANCE	±0.5mm

TITLE PG13 Cable Joiner Screw-in Type			
SCALE 1:1	SIZE A4	SHEET 1 OF 2	
REV. H	WC-REV. A.10	QC: Inspection item	

**Amphenol LTW**  
 安費諾亮泰企業股份有限公司

ITEM NO.	DRAWN BY Peng	DATE 2019-03-14
DWG NO. SC-L-PG13-XX-XX	CHECKED BY Ma Fei	DATE 2019-03-14
CUSTOMER ALTW	APPROVED BY Jerry	DATE 2019-03-14

THIS DOCUMENT IS SUBJECT TO CHANGE WITHOUT NOTICE. IT IS CONFIDENTIAL AND A PROPERTY OF Amphenol LTW. DISCLOSURE TO THIRD PARTY HAS TO BE AUTHORIZED BY Amphenol LTW.

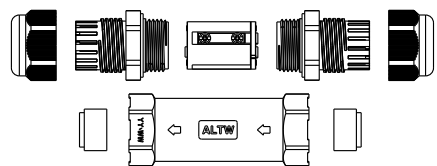

QTY: 1PCS

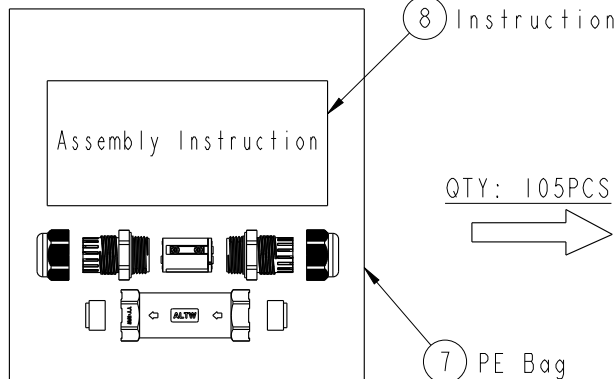
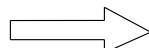

QTY: 105PCS

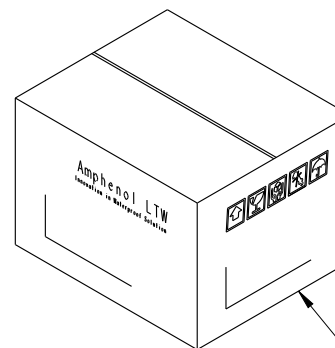
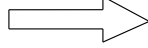

9 Carton

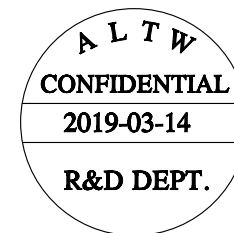

Both A Unassembled product And An Instruction Are In A PE Bag.  
(將一套未組裝的產品和說明書, 放置於一個PE袋, 並封口)

SC-L-PG13-XX-XX  
L: Cable Joiner  
Type: PG13

Seal's Color: BL-Blue(藍色) For Cable Range:  $\varnothing 4.5 \sim \varnothing 6.5\text{mm}$   
 YW-Yellow(黃色) For Cable Range:  $\varnothing 6.5 \sim \varnothing 8.5\text{mm}$   
 GN-Green(綠色) For Cable Range:  $\varnothing 8.5 \sim \varnothing 10.5\text{mm}$   
 RD-Red(紅色) For Cable Range:  $\varnothing 10.5 \sim \varnothing 11.5\text{mm}$   
 AA-All Seals For Cable Range:  $\varnothing 4.5 \sim \varnothing 11.5\text{mm}$

No. of Conductor: 02-2Poles  
 03-3Poles  
 04-4Poles  
 05-5Poles

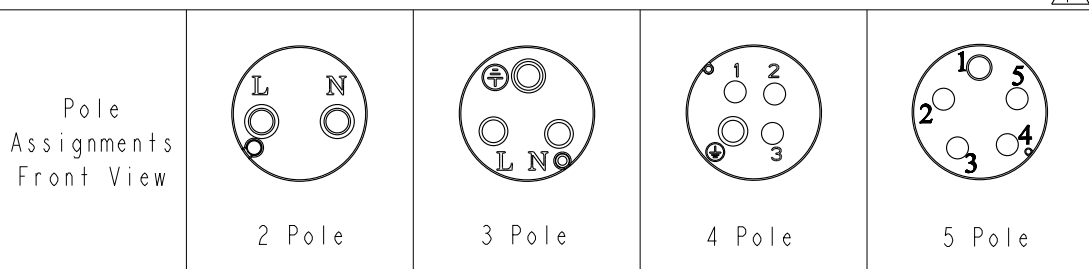

- Note:  $\triangle G$   $\triangle H$
- \*  $\text{⌀}$  Important Dimension To Check.
  - \* Waterproof Rate: IP68 (50M, 24H)
  - \* Housing & Cap: PA66+GF, Black.
  - \* Gland Pipe: PA66, Black.
  - \* Gland Body: PA66, Black.
  - \* Gland Nut: PA6+GF, Black.
  - \* Contact: Brass, Nickel Plated
  - \* L-Gasket: Silicone, Yellow.
  - \* Seal: Silicone, Blue & Yellow & Green & Red.
  - \* Rated Voltage: 2~5 Pole 450V AC
  - \* Rated Current: 2 & 3 Pole Max. 20A, 4 Pole Max. 15A, 5 Pole Max. 8A.
  - \* Operating Temperature:  $-40^{\circ} \sim +105^{\circ}$ .
  - \* Gland Pipe Recommended Tightening Torque: 8~10 Kgf.cm(0.78~0.98 N.m)
  - \* Gland Nut Recommended Tightening Torque: 8~10 Kgf.cm(0.78~0.98 N.m)
  - \* Seal For Cable OD:  $\varnothing 4.5 \sim \varnothing 6.5\text{mm}$ , Blue.  
 $\varnothing 6.5 \sim \varnothing 8.5\text{mm}$ , Yellow.  
 $\varnothing 8.5 \sim \varnothing 10.5\text{mm}$ , Green.  
 $\varnothing 10.5 \sim \varnothing 11.5\text{mm}$ , Red.
  - \* Screws for Wire connection recommended tightening torque: 2.00~4.50 kgf.cm / 0.196~0.44 N.m
  - \* Applicable Wire gauge (Stranded wire cross section)  $0.75\text{mm}^2$  (18AWG) ~  $2.5\text{mm}^2$  (14AWG)

UNIT:mm		TITLE PG13 Cable Joiner Screw-in Type	
TOLERANCE	$\pm 0.5\text{mm}$ $\triangle H$	SCALE 1:1	SIZE A4
		REV. H	WC-REV. A.10
		SHEET 2 OF 2	
		QC: Inspection item	

**Amphenol LTW**  
安費諾亮泰企業股份有限公司

ITEM NO	DRAWN BY Peng	DATE 2019-03-14
DWG NO SC-L-PG13-XX-XX	CHECKED BY Ma Fei	DATE 2019-03-14
CUSTOMER ALTW	APPROVED BY Jerry	DATE 2019-03-14