

DC Tubular Solenoid

Model T12x19



1425 Lake Avenue, Woodstock, IL 60098

Features:

High performance construction
Available return spring kit
DC solenoid applications only
See TP12x19 for push application
RoHS Compliant
UL recognized
Coil Termination: 6.5" Wire leads
22 AWG (standard)

Electrical:

Coil Voltages: 6, 12, 24, 48, 110 VDC standard
Duty Cycle: 100% Continuous, 25% Intermittent,
10% Intermittent, 1% Pulse
Coil treatment: Tape Wrapped
Insulation Class: Class A Rating - 105°C (221°F)
Dielectric Strength: 1500V 60 Hz

Mechanical:

Size: 2.38" (L) x 1.5" (D)
Plunger Diameter: 0.5"
Plunger Guide Material: Plastic
Mounting: Hex Nut
Weight: Plunger 2.2 oz, Total 14.2 oz
Life Expectancy: 1 Million Cycles¹

¹ - Dependent on load conditions

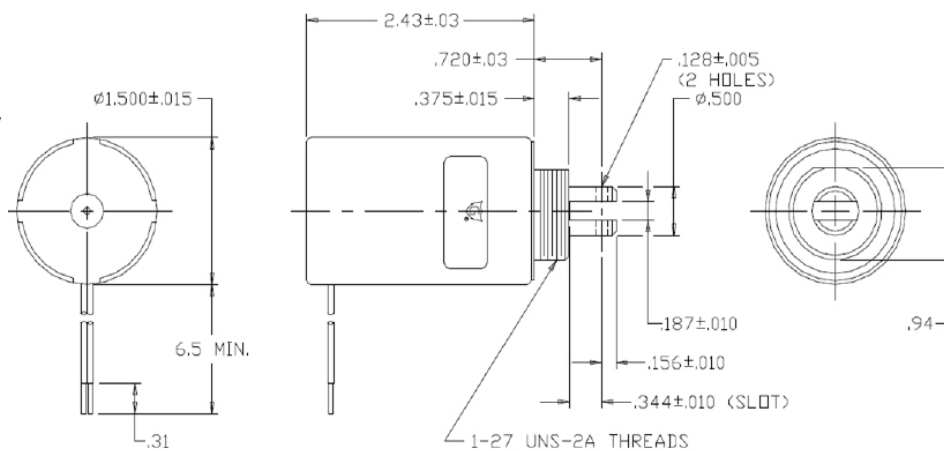

Standard Part Numbers

| Model | Part Number | Duty Cycle | Voltage | Resistance ² (Ω) | Power (W) | Current |
|--------------|----------------|------------|---------|-----------------------------|-----------|---------|
| T12x19-C-12D | A420-066842-00 | Cont. | 12VDC | 17.5 | 8.6 | 686 mA |
| T12x19-I-12D | A420-066843-00 | Inter. | 12VDC | 5.6 | 27 | 2.14 A |
| T12x19-C-24D | A420-066844-00 | Cont. | 24VDC | 68 | 8.9 | 353 mA |
| T12x19-I-24D | A420-066845-00 | Inter. | 24VDC | 22.1 | 27.4 | 1.09A |

² - Coil resistance tolerance +/- 5%

Contact us for custom voltages or duty cycles

Solenoid shown energized with plunger fully seated
Supplied with mounting bracket, hex nut and lock washer shipped loose

Available Customization:

- Plunger
- Lead and Connector
- DC Voltage / Duty Cycle
- Termination
- Insulation systems up to class H 180° C (356° F)

* Minimum quantities apply

| Typical Pull Force Ounces [N] @ 20°C (68°F) (Distance from fully seated position) | | | | | | | | | HOLDING FORCE Ounces [N] | Power (W) |
|--|------------|------------|------------|------------|------------|------------|-----------|-----------|--------------------------------|--------------|
| Stroke (in.) | 0.050 | 0.125 | 0.250 | 0.375 | 0.500 | 0.625 | 0.750 | 1.000 | | |
| Continuous 100% | 100 [27.8] | 60 [16.7] | 30 [8.3] | 20 [5.6] | 18 [5] | 15 [4.2] | 10 [2.8] | 8 [2.2] | 179 [49.8] | 8.6 |
| Intermittent 25% | 145 [40.3] | 110 [30.6] | 70 [19.5] | 50 [13.9] | 40 [11.1] | 35 [9.7] | 27 [7.5] | 20 [5.6] | 205 [57] | 27 |
| Intermittent 10% ³ | 220 [61.2] | 184 [51.2] | 145 [40.3] | 121 [33.6] | 102 [28.4] | 89 [24.7] | 73 [20.3] | 58 [16.1] | 546 [151.8] | 83 |
| Pulse 1% ³ | 252 [70.1] | 218 [60.6] | 180 [50.] | 154 [42.8] | 137 [38.1] | 125 [34.8] | 108 [30.] | 80 [22.2] | N/A | 130 |

Continuous Duty 100% = 100% On Time

Intermittent Duty 25% = 25% On Time (100 Sec On Max 300 Sec off)

Intermittent Duty 10% = 90% On Time (10 Sec On Max 90 Sec off)

Pulse Duty 1% = 99% On Time (1 Sec On Max 99 Sec off)

³ - Calculated force values to be verified in application

Optional Return Spring Kit

A490-367460-00



www.kelcoind.com

Information contained in this specification sheet subject to change without notice. Guardian Electric ©

