



TESZ1102/30

- **Double-insulated**
- **Thermoplastic enclosure**
- **111,5 mm x 92 mm x 36 mm**
- **2 cable entries M 20 x 1.5**
- **Good resistance to oil and petroleum spirit**
- **Simple fitting, especially on 30 mm profiles**

Data

Ordering data

Product type description	TESZ1102/30
Article number (order number)	101030045
EAN (European Article Number)	4030661448978
eCl@ss number, Version 9.0	27-27-06-09

Certifications

Certificates	DGUV cULus CCC EAC
--------------	-----------------------------

General data

Product name	TESZ
Standards	IEC/EN 60947-5-1 BG-GS-ET-15
Enclosure material	Plastic, glass-fibre reinforced thermoplastic, self-extinguishing
Material of the contacts, electrical	Silver
Material of the hinge	Aluminium
Gross weight	500 g

General data - Features

mounting hinge	Yes
Additional hinge	Yes
Number of auxiliary contacts	1

Number of safety contacts 2

Safety appraisal

Standards ISO 13849-1

Mission Time 20 Year(s)

Safety appraisal - Safety outputs

B10d Normally-closed contact (NC) 2,000,000 Operations

B10d Normally open contact (NO) 1,000,000 Operations

Mechanical data

Mechanical life, minimum 1,000,000 Operations

Positive break angle 14 °

Positive break force, minimum 1 N

Mechanical data - Connection technique

Terminal Connector Screw connection

Cable section, minimum 0.5 mm²

Cable section, maximum 1 mm²

Note (Cable section) All indications about the cable section are including the conductor ferrules.

Mechanical data - Dimensions

Length x Width x Height Suitable for mounting to profile systems: 30 mm

Height of sensor 92 mm

Length of sensor 36 mm

Width of sensor 111.5 mm

Ambient conditions

Protection class IP65

Ambient temperature, minimum -25 °C

Ambient temperature, maximum +65 °C

Ambient conditions - Insulation value

Rated impulse withstand voltage 2.5 kV

Electrical data

Thermal test current 2.5 A

Utilisation category AC-15 230 VAC

Utilisation category AC-15 2 A

Utilisation category DC-13 24 VDC

Utilisation category DC-13	1 A
Switching element	NO contact, NC contact
Switching principle	Creep circuit element
Switching frequency	120 /h

Notes

Note (General)	The opening angle has been set to 4° in factory. The additional hinge including mounting accessories is also available separately, part number TESZ/S/30
----------------	---

Ordering code

Product type description:

TESZ(1)(2)(3)(4)/(5)(6)/(7)

(1)

without Material of the hinge Aluminium

X Material of the hinge Stainless steel

(2)

R mechanische Wiederanlaufsperr

(3)

10 1 NC contact

102 1 NC contacts / 1 NO contact

110 2 NC contact

1102 2 NC contacts / 1 NO contacts

1110 3 NC contact

(4)

without Screw connection

ST1 Connector bottom (M12, 8 pole)

ST2 Connector top (M12, 8 pole)

(5)

without with additional hinge

S without additional hinge

(6)

30 Suitable for mounting to profile systems 30 mm

- 35** Suitable for mounting to profile systems 35 mm
- without** Suitable for mounting to profile systems 40 mm
- 45** Suitable for mounting to profile systems 45 mm

(7)

- without** Switching angle NC contact at 4 degrees
- 5°** Switching angle NC contact at 5 degrees
- 8°** Switching angle NC contact at 8 degrees

Pictures

Product picture (catalogue individual photo)



ID: ktez-f08

| 664,1 kB | .jpg | 352.778 x 419.1 mm - 1000 x 1188 Pixel - 72 dpi

| 56,0 kB | .png | 74.083 x 87.842 mm - 210 x 249 Pixel - 72 dpi

| 81,6 kB | .jpg | 27.093 x 32.173 mm - 320 x 380 Pixel - 300 dpi

Dimensional drawing basic component

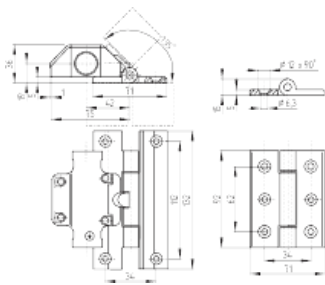

ID: 5tez-g01

| 43,7 kB | .jpg | 112.889 x 97.014 mm - 320 x 275 Pixel - 72 dpi

| 44,5 kB | .cdr |

| 191,8 kB | .jpg | 352.778 x 303.036 mm - 1000 x 859 Pixel - 72 dpi

| 6,2 kB | .png | 74.083 x 63.5 mm - 210 x 180 Pixel - 72 dpi

Switch travel diagram

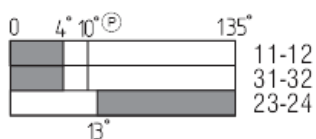

ID: ktes-s04

| 1,9 kB | .png | 74.083 x 29.633 mm - 210 x 84 Pixel - 72 dpi

| 17,1 kB | .jpg | 112.889 x 45.156 mm - 320 x 128 Pixel - 72 dpi

| 19,7 kB | .cdr |

Diagram

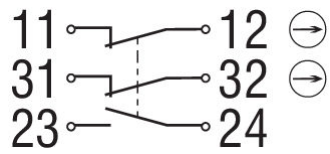

ID: ktes-k04

| 18,2 kB | .cdr |

| 25,0 kB | .jpg | 112.889 x 49.389 mm - 320 x 140

Pixel - 72 dpi

K.A. Schmersal GmbH & Co. KG, Möddinghofe 3, D-42279 Wuppertal

The details and data referred to have been carefully checked. Images may diverge from original. Further technical data can be found in the manual. Technical amendments and errors possible.

Generated on 08.07.2020 17:24:11