

RSS16-D-ST8H



- without latching
- Series-wiring unlimited
- Thermoplastic enclosure
- Suitable for series-wiring
- 1 x connector plug M12, 8-pole
- Door stop with magnetic latching
- 3 different directions of actuation
- Universal coding with RFID technology
- Connection terminal or plug connection
- RFID-technology for needs-based protection against tampering

Data

Ordering data

Product type description	RSS16-D-ST8H
Article number (order number)	103004370
EAN (European Article Number)	4030661456843
eCl@ss number, Version 9.0	27-27-24-03

Certifications

Certificates	TÜV
	cULus
	EAC
	FCC
	IC

General data

Product name	RSS16
Standards	IEC 60947-5-3
general information	Universal coding
	Low
Active principle	RFID
Housing construction form	Block
Installation conditions (mechanical)	not flush
Sensor topology	Sensor for series wiring

Enclosure material	Plastic, glass-fibre reinforced thermoplastic, self-extinguishing
Active area	Glass-fibre, reinforced thermoplastic
Gross weight	160 g
Time to readiness, maximum	2,000 ms
Reaction time, maximum	100 ms
Duration of risk, maximum	200 ms

General data - Features

Diagnostic output	Yes
Short circuit detection	Yes
Short-circuit recognition	Yes
Series-wiring	Yes
Safety functions	Yes
Cascadable	Yes
Integral System Diagnostics, status	Yes
Number of LEDs	2
Number of semi-conductor outputs with signaling function	1
Number of fail-safe digital outputs	2

Safety appraisal

Standards	ISO 13849-1 IEC 60947-5-3 EN 62061 IEC 61508
Performance Level	e
Control category to EN13849	4
PFH-value	6.30×10^{-11} /h
Safety Integrity Level (SIL)	3
Mission Time	20 Year(s)

Mechanical data

Actuating panels	front side rear from head
Active area	lateral front side cover-side
Mounting	2 x M5, Cylinder head screw
Switch distance	15 mm
Ensured switch distance "ON" S_{ao}	12 mm
Ensured switch distance "OFF" S_{ar}	30 mm
Hysteresis (Switch distance), maximum	2 mm
Repeat accuracy R R	0.5 mm

Tightening torque of nuts, maximum 2 Nm

Mechanical data - Connection technique

Terminal Connector	Connector M12, 8-pole
Note	The cable section of the interconnecting cable must be observed for both wiring variants! Cable length and cable section alter the voltage drop depending on the output current

Mechanical data - Dimensions

Height of sensor	30 mm
Length of sensor	91 mm
Width of sensor	52 mm

Ambient conditions

Protection class	IP 65 to IEC/EN 60529 IP 66 to IEC/EN 60529 IP 67 to IEC/EN 60529
Ambient temperature, minimum	-25 °C
Ambient temperature, maximum	+70 °C
Storage and transport temperature, minimum	-25 °C
Storage and transport temperature, maximum	+85 °C
Resistance to shock	30 g / 11 ms

Ambient conditions - Insulation value

Rated impulse withstand voltage	0.8 kV III
Degree of pollution to VDE 0100	3

Electrical data

Voltage type	DC (direct current)
No-load current	100 mA
Rated operating voltage, minimum	20.4 VDC
Rated operating voltage, maximum	26.4 VDC
Operating current	2,100 mA
Required rated short-circuit current to EN 60947-5-1	100 A
Switching frequency, approx.	1 Hz

Electrical data - Fail-safe digital outputs

Rated operating current (safety outputs)	1,000 mA
------------------------------------------	----------

Output current, (fail-safe output), maximum	1 A
	P-type
	1 V
Current leakage	0.5 mA

Electrical data - Diagnostic output

Operating current (diagnostic output)	50 mA
	P-type
	2 V

Electrical data - Electromagnetic compatibility (EMC)

IEC 61000-6-4
IEC 60947-3

Status indication

Note (LED switching conditions display)	Multi-coloured LED: Green, Red LED yellow: Operating condition LED green: Supply voltage LED red: Fault
-----------------------------------------	------------------------------------------------------------------------------------------------------------------

Scope of delivery

Included in delivery	Actuators must be ordered separately.
----------------------	---------------------------------------

Accessory

Recommendation (actuator)	RST16-1 RST-U-2 PROTECT PSC1 SRB-E-301ST SRB-E-201LC
---------------------------	------------------------------------------------------------------

Ordering code

Product type description:

RSS16 (1)-(2)-(3)-(4)

(1)

without Standard coding

I1 Individual coding

I2 Individual coding, for multiple applications

(2)

D With diagnostic output

SD With serial diagnostic function

(3)

without without latching

R With latching, latching force 40 ... 60 N

(4)

ST8H With connector plug M12 in the middle

CC with cage clamps

SK Screw connection

Pictures

Product picture (catalogue individual photo)



ID: krss1f02

| 100,6 kB | .png | 74.083 x 156.633 mm - 210 x 444
Pixel - 72 dpi

| 166,4 kB | .jpg | 27.093 x 57.235 mm - 320 x 676
Pixel - 300 dpi

| 1,3 MB | .jpg | 352.778 x 745.772 mm - 1000 x 2114
Pixel - 72 dpi

Dimensional drawing basic component

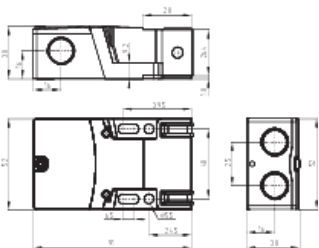

ID: krss1g01

| 33,8 kB | .jpg | 112.889 x 86.078 mm - 320 x 244
Pixel - 72 dpi

| 4,7 kB | .png | 74.083 x 56.444 mm - 210 x 160 Pixel
- 72 dpi

| 141,1 kB | .jpg | 352.778 x 268.817 mm - 1000 x 762
Pixel - 72 dpi

K.A. Schmersal GmbH & Co. KG, Möddinghofe 3, D-42279 Wuppertal

The details and data referred to have been carefully checked. Images may diverge from original. Further technical data can be found in the manual. Technical amendments and errors possible.

Generated on 08.07.2020 15:55:23