

## RSS16-D-SK



- Screw connection
- without latching
- Thermoplastic enclosure
- Series-wiring unlimited
- Suitable for series-wiring
- Door stop with magnetic latching
- 3 different directions of actuation
- Universal coding with RFID technology
- Connection terminal or plug connection
- RFID-technology for needs-based protection against tampering

### Data

#### Ordering data

|                               |               |
|-------------------------------|---------------|
| Product type description      | RSS16-D-SK    |
| Article number (order number) | 103004343     |
| EAN (European Article Number) | 4030661456881 |
| eCl@ss number, Version 9.0    | 27-27-24-03   |

#### Certifications

|              |       |
|--------------|-------|
| Certificates | TÜV   |
|              | cULus |
|              | EAC   |
|              | FCC   |
|              | IC    |

#### General data

|                                      |   |
|--------------------------------------|---|
| Product name                         | RSS16   |
| Standards                            | IEC 60947-5-3   |
| general information                  | Universal coding  |
|                                      | Low   |
| Active principle                     | RFID  |
| Housing construction form            | Block   |
| Installation conditions (mechanical) | not flush   |
| Sensor topology                      | Sensor for series wiring  |
| Enclosure material                   | Plastic, glass-fibre reinforced thermoplastic, self-extinguishing |

|                            |                                       |
|----------------------------|---------------------------------------|
| Active area                | Glass-fibre, reinforced thermoplastic |
| Gross weight               | 250 g                                 |
| Time to readiness, maximum | 2,000 ms                              |
| Reaction time, maximum     | 100 ms                                |
| Duration of risk, maximum  | 200 ms                                |

### General data - Features

|  |     |
|--|-----|
| Diagnostic output  | Yes |
| Short circuit detection                                  | Yes |
| Short-circuit recognition                                | Yes |
| Series-wiring  | Yes |
| Safety functions   | Yes |
| Cascadable   | Yes |
| Integral System Diagnostics, status                      | Yes |
| Number of LEDs   | 2   |
| Number of semi-conductor outputs with signaling function | 1   |
| Number of fail-safe digital outputs                      | 2   |

### Safety appraisal

|                              |   |
|------------------------------|---|
| Standards                    | ISO 13849-1<br>IEC 60947-5-3<br>EN 62061<br>IEC 61508 |
| Performance Level            | e   |
| Control category to EN13849  | 4   |
| PFH-value                    | $6.30 \times 10^{-11}$ /h                             |
| Safety Integrity Level (SIL) | 3   |
| Mission Time                 | 20 Year(s)  |

### Mechanical data

|  |  |
|--|--|
| Actuating panels                       | front side<br>rear<br>from head<br>lateral |
| Active area                            | front side<br>cover-side                   |
| Mounting                               | 2 x M5, Cylinder head screw                |
| Switch distance                        | 15 mm                                      |
| Ensured switch distance "ON" $S_{ao}$  | 12 mm                                      |
| Ensured switch distance "OFF" $S_{ar}$ | 30 mm                                      |
| Hysteresis (Switch distance), maximum  | 2 mm                                       |
| Repeat accuracy R R                    | 0.5 mm                                     |
| Tightening torque of nuts, maximum     | 2 Nm                                       |

## Mechanical data - Connection technique

|                    |   |
|--------------------|---|
| Terminal Connector | Screw connection  |
| Note               | The cable section of the interconnecting cable must be observed for both wiring variants! Cable length and cable section alter the voltage drop depending on the output current |

## Mechanical data - Dimensions

|                  |       |
|------------------|-------|
| Height of sensor | 30 mm |
| Length of sensor | 91 mm |
| Width of sensor  | 52 mm |

## Ambient conditions

|  |  |
|--|--|
| Protection class                           | IP 65 to IEC/EN 60529<br>IP 67 to IEC/EN 60529 |
| Ambient temperature, minimum               | -25 °C   |
| Ambient temperature, maximum               | +70 °C   |
| Storage and transport temperature, minimum | -25 °C   |
| Storage and transport temperature, maximum | +85 °C   |
| Resistance to shock                        | 30 g / 11 ms                                   |

## Ambient conditions - Insulation value

|                                 |               |
|---------------------------------|---------------|
| Rated impulse withstand voltage | 0.8 kV<br>III |
| Degree of pollution to VDE 0100 | 3             |

## Electrical data

|  |                     |
|--|---------------------|
| Voltage type   | DC (direct current) |
| No-load current                                      | 100 mA              |
| Rated operating voltage, minimum                     | 20.4 VDC            |
| Rated operating voltage, maximum                     | 26.4 VDC            |
| Operating current                                    | 2,100 mA            |
| Required rated short-circuit current to EN 60947-5-1 | 100 A               |
| Switching frequency, approx.                         | 1 Hz                |

## Electrical data - Fail-safe digital outputs

|   |          |
|---|----------|
| Rated operating current (safety outputs)    | 1,000 mA |
| Output current, (fail-safe output), maximum | 1 A      |

|                 |        |
|-----------------|--------|
|                 | P-type |
|                 | 1 V    |
| Current leakage | 0.5 mA |

### Electrical data - Diagnostic output

|                                       |        |
|---------------------------------------|--------|
| Operating current (diagnostic output) | 50 mA  |
|                                       | P-type |
|                                       | 2 V    |

### Electrical data - Electromagnetic compatibility (EMC)

IEC 61000-6-4  
IEC 60947-3

### Status indication

|   |  |
|---|--|
| Note (LED switching conditions display) | Multi-coloured LED: Green, Red<br>LED yellow: Operating condition<br>LED green: Supply voltage<br>LED red: Fault |
|---|--|

### Scope of delivery

|                      |                                       |
|----------------------|---------------------------------------|
| Included in delivery | Actuators must be ordered separately. |
|----------------------|---------------------------------------|

### Accessory

|                           |  |
|---------------------------|--|
| Recommendation (actuator) | RST16-1<br>RST-U-2<br>PROTECT PSC1<br>SRB-E-301ST<br>SRB-E-201LC |
|---------------------------|--|

### Ordering code

Product type description:

RSS16 (1)-(2)-(3)-(4)

(1)

**without** Standard coding

**I1** Individual coding

**I2** Individual coding, for multiple applications

(2)

- D** With diagnostic output
- SD** With serial diagnostic function

(3)

**without** without latching

- R** With latching, latching force 40 ... 60 N

(4)

**ST8H** With connector plug M12 in the middle

**CC** with cage clamps

**SK** Screw connection

## Pictures

### Product picture (catalogue individual photo)



ID: krss1f08



| 1,3 MB | .jpg | 352.778 x 745.772 mm - 1000 x 2114

Pixel - 72 dpi

| 162,5 kB | .jpg | 27.093 x 57.235 mm - 320 x 676

Pixel - 300 dpi

| 97,9 kB | .png | 74.083 x 156.633 mm - 210 x 444

Pixel - 72 dpi

### Dimensional drawing basic component

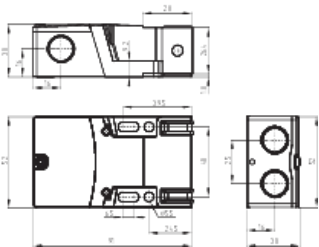

ID: krss1g01

| 33,8 kB | .jpg | 112.889 x 86.078 mm - 320 x 244

Pixel - 72 dpi

| 4,7 kB | .png | 74.083 x 56.444 mm - 210 x 160 Pixel

- 72 dpi

| 141,1 kB | .jpg | 352.778 x 268.817 mm - 1000 x 762

Pixel - 72 dpi

K.A. Schmersal GmbH & Co. KG, Möddinghofe 3, D-42279 Wuppertal

The details and data referred to have been carefully checked. Images may diverge from original. Further technical data can be found in the manual. Technical amendments and errors possible.

Generated on 08.07.2020 15:54:51