

## AZM161SK-12/12RKA-M16-110/230V



- Long life
- 6 Contacts
- Manual release
- Double-insulated
- 130 mm x 90 mm x 30 mm
- Thermoplastic enclosure
- Large wiring compartment
- cable entries 4 M 16 x 1.5
- Interlock with protection against incorrect locking.

### Data

#### Ordering data

|                               |                            |
|-------------------------------|----------------------------|
| Product type description      | AZM 161SK-12/12RKA-110/230 |
| Article number (order number) | 101166286                  |
| EAN (European Article Number) | 4030661213989              |
| eCl@ss number, Version 9.0    | 27-27-26-03                |

#### Certifications

|              |       |
|--------------|-------|
| Certificates | CE    |
|              | cULus |
|              | CCC   |
|              | EAC   |

#### General data

|                                      |   |
|--------------------------------------|---|
| Product name                         | AZM 161   |
| Standards                            | EN 60947-5-1<br>BG-GS-ET-19                                       |
| Active principle                     | Low<br>electromechanical  |
| Enclosure material                   | Plastic, glass-fibre reinforced thermoplastic, self-extinguishing |
| Material of the contacts, electrical | Silver  |
| Gross weight                         | 415 g   |

#### General data - Features

|               |     |
|---------------|-----|
| Power to lock | Yes |
|---------------|-----|

|                                |     |
|--------------------------------|-----|
| Manual release                 | Yes |
| Number of actuating directions | 3   |
| Number of auxiliary contacts   | 2   |
| Number of safety contacts      | 4   |

### Safety appraisal

|              |             |
|--------------|-------------|
| Standards    | ISO 13849-1 |
| Mission Time | 20 Year(s)  |

### Safety appraisal - Safety outputs

|                                   |                      |
|-----------------------------------|----------------------|
| B10d Normally-closed contact (NC) | 2,000,000 Operations |
| B10d Normally open contact (NO)   | 1,000,000 Operations |

### Mechanical data

|  |                      |
|--|----------------------|
| Mechanical life, minimum                   | 1,000,000 Operations |
| Actuating play in direction of actuation   | 5.5 mm               |
| Clamping force in accordance with ISO14119 | 2,000 N              |
| $F_{zh}$                                   |                      |
| Latching force                             | 30 N                 |
| positive break travel                      | 10 mm                |
| Positive break force, minimum              | 20 N                 |
| Actuating speed, maximum                   | 2 m/s                |

### Mechanical data - Connection technique

|                        |   |
|------------------------|---|
| Terminal Connector     | Screw terminals   |
| Cable section, minimum | 1 x 0.25 mm <sup>2</sup>  |
| Cable section, maximum | 1 x 1.5 mm <sup>2</sup>   |
| Note (Cable section)   | All indications about the cable section are including the conductor ferrules. |

### Mechanical data - Dimensions

|                  |        |
|------------------|--------|
| Height of sensor | 90 mm  |
| Length of sensor | 30 mm  |
| Width of sensor  | 130 mm |

### Ambient conditions

|                              |                       |
|------------------------------|-----------------------|
| Protection class             | IP 67 to IEC/EN 60529 |
| Ambient temperature, minimum | -25 °C                |
| Ambient temperature, maximum | +60 °C                |

### Ambient conditions - Insulation value

|                                 |      |
|---------------------------------|------|
| Rated impulse withstand voltage | 4 kV |
|---------------------------------|------|

## Electrical data

|  |                        |
|--|------------------------|
| Thermal test current                                 | 6 A                    |
| Rated control voltage                                | 230 VAC                |
| Required rated short-circuit current to EN 60947-5-1 | 1,000 A                |
| Electrical power consumption, maximum                | 10 W                   |
| Switching element                                    | NO contact, NC contact |
| Switching principle                                  | Creep circuit element  |
| Switching frequency                                  | 1,000 /h               |

## Other data

|                     |  |
|---------------------|--|
| Note (applications) | sliding safety guard<br>removable guard<br>hinged safety guard |
|---------------------|--|

## Scope of delivery

|                      |                                       |
|----------------------|---------------------------------------|
| Included in delivery | Actuators must be ordered separately. |
|----------------------|---------------------------------------|

## Notes

|                       |   |
|-----------------------|---|
| Note (Manual release) | For maintenance, installation, etc.<br>For manual release using M5 triangular key, available as accessory |
|-----------------------|---|

## Ordering code

Product type description:

AZM 161 (1)-(2)(3)K(4)-(5)-(6)(7)

(1)

|           |  |
|-----------|--|
| <b>SK</b> | Screw connection                                     |
| <b>CC</b> | Cage clamps  |
| <b>ST</b> | Connector M12, 8 and 4 pole (only for Us: 24 VAC/DC) |

(2)

|              |  |
|--------------|--|
| <b>12/12</b> | 2 NO contacts/4 NC contacts                      |
| <b>12/11</b> | 2 NO contacts / 3 NC contacts (conector version) |
| <b>11/12</b> | 2 NO contacts / 3 NC contacts (conector version) |

(3)

**without** Latching force 5 N

**R** Latching force 30 N

(4)

**without** Power to unlock

**A** Power to lock

(5)

**without** Lateral manual release

**ED** Manual release on the cover side

**EU** Manual release on the rear side

**T** Lateral emergency exit

**TD** Emergency exit on the cover side

**TU** Emergency exit on the rear side

**N** Emergency release

(6)

**024** Us: 24 VAC/DC

**110/230** Us: 110/230 VAC

(7)

**G** with LED (only for Us: 24 VAC/DC)

## Pictures

### Product picture (catalogue individual photo)



ID: kazm1f03

| 36,6 kB | .png | 74.083 x 55.739 mm - 210 x 158

Pixel - 72 dpi

| 60,1 kB | .jpg | 22.831 x 17.195 mm - 320 x 241 Pixel  
- 356 dpi

| 698,5 kB | .jpg | 352.778 x 265.289 mm - 1000 x 752  
Pixel - 72 dpi

### Product picture (catalogue individual photo)

ID: sazm1f03



| 364,3 kB | .jpg | 352.778 x 265.289 mm - 1000 x 752 Pixel - 72 dpi

| 25,3 kB | .png | 74.083 x 55.739 mm - 210 x 158 Pixel - 72 dpi

| 38,1 kB | .jpg | 22.831 x 17.195 mm - 320 x 241 Pixel - 356 dpi

### Dimensional drawing basic component

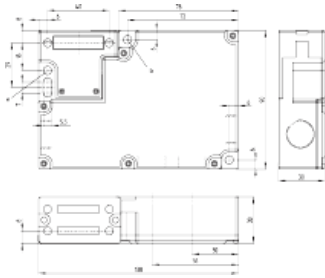

ID: kazm1g09

| 4,5 kB | .png | 74.083 x 62.442 mm - 210 x 177 Pixel - 72 dpi

| 139,6 kB | .jpg | 352.778 x 298.097 mm - 1000 x 845 Pixel - 72 dpi

| 34,7 kB | .jpg | 112.889 x 95.25 mm - 320 x 270 Pixel - 72 dpi

| 137,3 kB | .cdr |

### Switch travel diagram

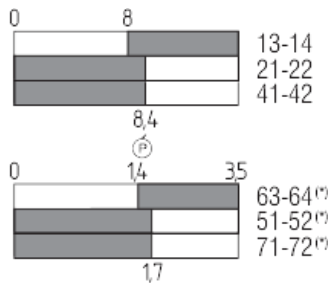

ID: kazm1s07

| 28,7 kB | .jpg | 112.889 x 97.367 mm - 320 x 276 Pixel - 72 dpi

| 17,7 kB | .cdr |

| 2,9 kB | .png | 74.083 x 63.853 mm - 210 x 181 Pixel - 72 dpi

### Diagram

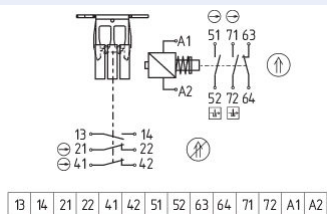

ID: kazm1k30

| 30,5 kB | .jpg | 112.889 x 72.672 mm - 320 x 206 Pixel - 72 dpi

### Operating principle

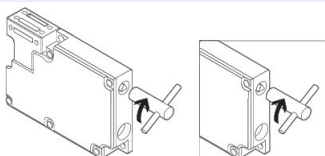

ID: kazm1a41

| 48,4 kB | .cdr |

K.A. Schmersal GmbH & Co. KG, Möddinghofe 3, D-42279 Wuppertal

The details and data referred to have been carefully checked. Images may diverge from original. Further technical data can be found in the manual. Technical amendments and errors possible.

Generated on 08.07.2020 18:55:55