

AZM170SK-12/00ZRK-2197-24VAC/DC



- Long life
 - Compact design
 - Double-insulated
 - High holding force
 - 90 mm x 84 mm x 30 mm
 - Cut clamp termination
 - Thermoplastic enclosure
 - 1 Cable entry M 20 x 1.5
 - Manual release from side
- Interlock with protection against incorrect locking.

Data

Ordering data

Product type description	AZM 170SK-12/00ZRK-2197 24 VAC/DC
Article number (order number)	101183013
EAN (European Article Number)	4030661318660
eCI@ss number, Version 9.0	27-27-26-03

Certifications

Certificates	CE
	cULus
	CCC
	EAC

General data

Product name	AZM 170
Standards	EN 60947-5-1
	BG-GS-ET-19
	Low
Active principle	electromechanical
Enclosure material	Plastic, glass-fibre reinforced thermoplastic, self-extinguishing
Material of the contacts, electrical	Silver
Gross weight	357 g

General data - Features

Power to unlock	Yes
Manual release	Yes
Number of actuating directions	2
Number of auxiliary contacts	1
Number of safety contacts	2

Safety appraisal

Standards	ISO 13849-1
Mission Time	20 Year(s)

Safety appraisal - Safety outputs

B10d Normally-closed contact (NC)	2,000,000 Operations
-----------------------------------	----------------------

Mechanical data

Mechanical life, minimum	1,000,000 Operations
Clamping force in accordance with ISO14119 F_{zh}	1,000 N
Latching force	30 N
positive break travel	11 mm
Positive break force, minimum	8.5 N
Actuating speed, maximum	2 m/s

Mechanical data - Connection technique

Terminal Connector	Screw terminals
Cable section, minimum	1 x 0.25 mm ²
Cable section, maximum	1 x 1.5 mm ² , flexible

Mechanical data - Dimensions

Height of sensor	100.5 mm
Length of sensor	30 mm
Width of sensor	108 mm

Ambient conditions

Protection class	IP 67 to IEC/EN 60529
Ambient temperature, minimum	-25 °C
Ambient temperature, maximum	+60 °C

Ambient conditions - Insulation value

Rated impulse withstand voltage	4 kV
---------------------------------	------

Electrical data

Thermal test current	6 A 24 VAC/DC
Required rated short-circuit current to EN 60947-5-1	1,000 A
Electrical power consumption, maximum	10 W
Switching element	NO contact, NC contact
Note (Switching element)	Change-over contact with double break, type Zb or 2 NC contacts, with galvanically separated contact bridges
Switching principle	Creep circuit element
Switching frequency	1,000 /h

Other data

Note (applications)	sliding safety guard removable guard hinged safety guard
---------------------	--

Scope of delivery

Included in delivery	Actuators must be ordered separately.
----------------------	---------------------------------------

Notes

Note (General)	Individual coding available on request right
Note (Manual release)	For manual release using M5 triangular key, available as accessory Additional manual release on side

Ordering code

Product type description:

AZM 170(1)-(2)Z(3)K(4)-(5)-(6)-(7)

(1)

without IDC method of termination

SK Screw connection

(2)

11 1 NO contacts/1 NC contact

02 2 NC contact

(3)

without Latching force 5 N

R Latching force 30 N

I Individual coding

(4)

without Power to unlock

A Power to lock

(5)

without cable gland

ST M12 x 1 connector

ST-2431 Connector M12 x 1, individual solenoid monitoring

(6)

24VAC/DC Us 24 VAC/DC

110VAC Us 110 VAC

230VAC Us 230 VAC

(7)

without Manual release

2197 Manual release from side (Power to unlock)

1637 Gold-plated contacts

(1)

11/11 1 NO contact, 1 NC contact / 1 NO contact 1, NC contact

11/02 1 NO contact, 1 NC contact / 2 NC contacts

12/00 1 NO contact, 2 NC contacts / -

12/11 1 NO contact, 2 NC contact / 1 NO contact 1, NC contact

12/02 1 NO contact, 2 NC contact / 2 NC contacts

02/01 2 NC contacts / 1 NC contact

02/10 2 NC contacts, - / 1 NO contact

(2)

without Latching force 5 N

R Latching force 30 N

(3)

without Power to unlock

A Power to lock

(4)

1637 Gold-plated contacts

(5)

2197 Manual release for Power to unlock

Pictures

Product picture (catalogue individual photo)



ID: kazm1f10

| 50,6 kB | .png | 74.083 x 69.85 mm - 210 x 198 Pixel
- 72 dpi

| 78,9 kB | .jpg | 26.649 x 25.067 mm - 320 x 301 Pixel
- 305 dpi

| 491,5 kB | .jpg | 243.769 x 229.658 mm - 691 x 651
Pixel - 72 dpi

Dimensional drawing basic component

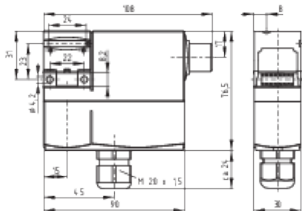

ID: 1azm1g07

| 32,7 kB | .jpg | 112.889 x 78.317 mm - 320 x 222
Pixel - 72 dpi

| 126,8 kB | .jpg | 352.778 x 245.181 mm - 1000 x 695
Pixel - 72 dpi

| 44,4 kB | .cdr |

| 10,1 kB | .png | 74.083 x 51.506 mm - 210 x 146
Pixel - 72 dpi

Diagram

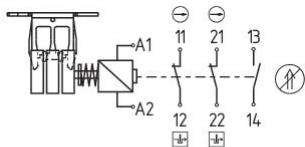

ID: kazm1k83

| 26,4 kB | .jpg | 112.889 x 81.844 mm - 320 x 232
Pixel - 72 dpi

11	12	21	22	13	14	A1	A2
----	----	----	----	----	----	----	----

K.A. Schmersal GmbH & Co. KG, Möddinghofe 3, D-42279 Wuppertal

The details and data referred to have been carefully checked. Images may diverge from original. Further technical data can be found in the manual. Technical amendments and errors possible.

Generated on 08.07.2020 18:59:01