

Copper Mechanical Connectors

All the outstanding LOCKTITE® lug features — plus two-bolt capacity.

LOCKTITE® One-Hole 90° Upright Lugs



- For use with code copper conductor (600V)



CAT. NO.	CABLE SIZE	DIMENSIONS (IN.)						
		G	A	B	C	D	J	F
31005-UAL [†]	8 to 4	¼	1½	⅝	½	⅛	½	⅞
31007-UAL	4 to 1	¼	1 ²¹ / ₃₂	13 ¹ / ₁₆	⅝	7 ¹ / ₃₂	19 ¹ / ₁₆	11 ¹ / ₃₂
31009-UAL	1 to 2/0	⅜	2 ¹ / ₃₂	1	19 ¹ / ₁₆	¼	19 ¹ / ₁₆	7 ¹ / ₁₆
31011-UAL	2/0 to 4/0	⅜	2½	1¼	1	9 ¹ / ₃₂	1½	17 ¹ / ₃₂

[†]With Filister Head Screw. All others, hex head screws.

Bolt holes and spacings listed are standard, but lugs with blank tongues can be furnished.

LOCKTITE® Two-Hole Lugs

- Easy installation
- High conductivity
- Wide cable range
- Long tongue adapted for two bolts
- For use with code copper conductor (600V)

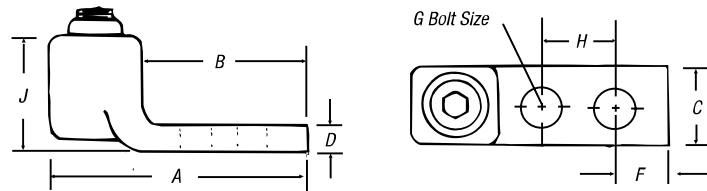

CAT. NO.	CABLE SIZE	DIMENSIONS (IN.)							
		G	A	B	C	D	J	F	H
32003 [†]	14 to 8	¼	1 ¹¹ / ₁₆	1¼	½	⅛	15 ¹ / ₃₂	9 ¹ / ₃₂	⅝
32005 [†]	8 to 4	¼	1¾	1¼	½	⅛	17 ¹ / ₃₂	9 ¹ / ₃₂	⅝
32007	4 to 1	¼	2¼	1 ¹ / ₁₆	⅝	7 ¹ / ₃₂	7 ¹ / ₈	9 ¹ / ₃₂	¾
32009	1 to 2/0	⅜	2 ¹ / ₈	1 ¹⁵ / ₁₆	13 ¹ / ₁₆	¼	13 ¹ / ₃₂	7 ¹ / ₁₆	1
32011	2/0 to 4/0	⅜	3 ¹ / ₈	2	1	9 ¹ / ₃₂	15 ¹ / ₁₆	7 ¹ / ₁₆	1
32013	4/0 to 300	⅜	3 ³ / ₈	2 ¹ / ₈	1 ¹ / ₁₆	5 ¹ / ₁₆	1 ¹ / ₁₆	7 ¹ / ₁₆	1
32015	300 to 500	⅜	3½	2 ¹ / ₈	1 ¹ / ₈	1 ¹ / ₃₂	1 ²⁷ / ₃₂	7 ¹ / ₁₆	1
32017	500 to 750	½	4 ¹⁹ / ₃₂	3	1¾	13 ¹ / ₃₂	2 ¹ / ₈	9 ¹ / ₁₆	1½
32019	750 to 1,000	½	4 ²⁷ / ₃₂	3	1 ¹ / ₈	15 ¹ / ₃₂	2 ¹¹ / ₃₂	9 ¹ / ₁₆	1½

[†]With Filister Head Screw. All others, hex head screws.

For torque requirements, see page F-188.

LOCKTITE® Two-Hole NEMA-Drilled Lugs

- Furnished with bolt holes and spacings to fit equipment with NEMA-type connector mounting pads
- For use with code copper conductor (600V)

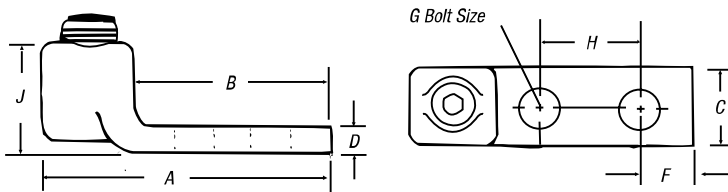

CAT. NO.	CABLE SIZE	DIMENSIONS (IN.)							
		G	A	B	C	D	J	F	H
32207	4 to 1	⅜	2 ¹³ / ₁₆	2	¾	7 ¹ / ₃₂	7 ¹ / ₈	7 ¹ / ₁₆	1
32209	1 to 2/0	½	3 ¹⁵ / ₁₆	3	1	¼	11 ¹ / ₁₆	9 ¹ / ₁₆	1¾
32211	2/0 to 4/0	½	4 ¹ / ₈	3	1	9 ¹ / ₃₂	19 ¹ / ₃₂	9 ¹ / ₁₆	1¾
32213	4/0 to 300	½	4 ¹ / ₈	3	1 ¹ / ₁₆	5 ¹ / ₁₆	1 ¹⁵ / ₃₂	9 ¹ / ₁₆	1¾
32215	300 to 500	½	4 ⁷ / ₈	3½	1 ¹ / ₈	1 ¹ / ₃₂	1 ¹³ / ₁₆	9 ¹ / ₁₆	1¾
32217	500 to 750	½	5 ⁵ / ₃₂	3½	1¾	13 ¹ / ₃₂	2 ¹ / ₈	9 ¹ / ₁₆	1¾
32219	750 to 1,000	½	5¼	3½	3	15 ¹ / ₃₂	2 ¹ / ₈	9 ¹ / ₁₆	1¾

For torque requirements, see page F-188.