

# POBCO Stainless Steel Support Rods

with reinforced polyamide clip end (stainless rods are hollow)

STYLE	PART NUMBER	A	B	ROD DIA.
R	PAR08RoundL5.5	5.50	1.00	1/2"
R	PAR08RoundL7.38	7.375	1.00	1/2"
F	PAR08L5	5.50	1.00	1/2"
F	PAR08L7	7.375	1.00	1/2"
R	PAR08ROUNDL11.25	11.25	1.00	1/2"
F	PAR08L11.25	11.25	1.00	1/2"

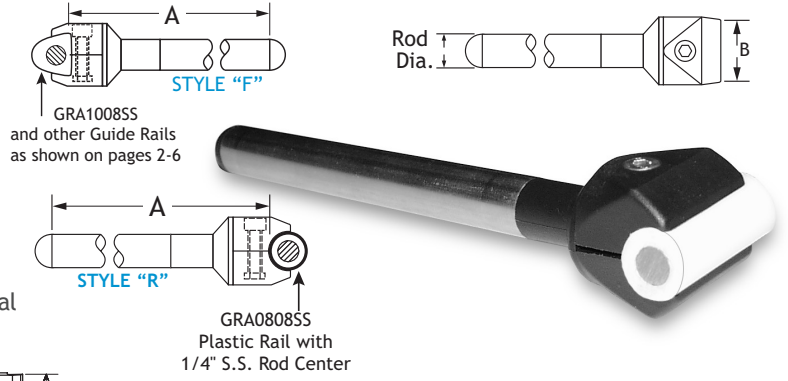

Clamp for Guide Rail GRA-0808-SS or any 1/2" diameter material

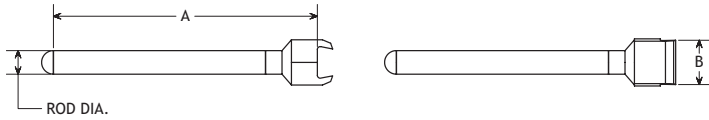

## POBCO Pivot End Adjusting Rods

### Stainless Steel Jointed 1/2" Dia. Support Rods

Pivot End Adjusting Rods are made of 303 stainless steel. The jointed ends have an internal thread of 5/16-18 and allow for POBCO clips or threaded bolts. Pivot ends allow these rods to support rails around curves and bends of conveyor systems.

MATERIAL	THREAD	DIA.	LENGTH	PART NUMBER
Stainless Steel	5/16"-18	1/2	5	JSRSS0518L5
Stainless Steel	5/16"-18	1/2	7	JSRSS0518L7
Stainless Steel	5/16"-18	1/2	9	JSRSS0518L9

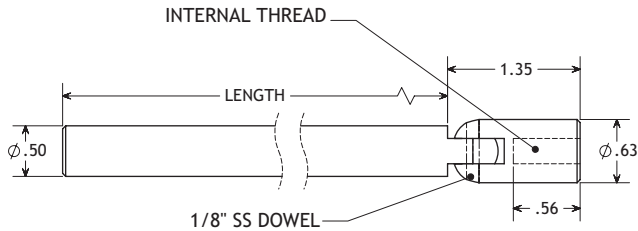
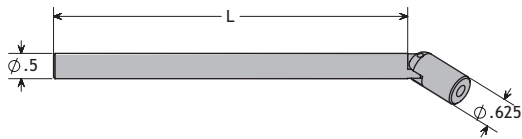

## POBCO Rod Ends



**PVG02001**  
Fits with Flat Bottom Guide Rails

**PVG01912**  
Fits with 1/2" dia Round Rails

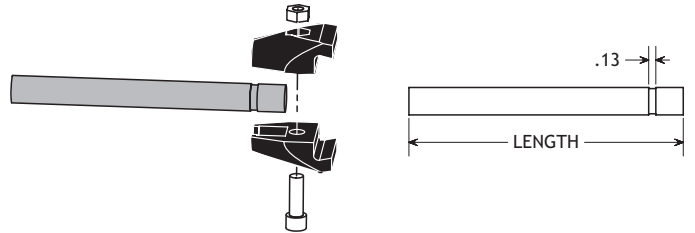

## POBCO Adjusting Rods for Rod Ends

MATERIAL	DIA.	LENGTH	PART NUMBER
Stainless Steel	1/2	5	PVG020R5
Stainless Steel	1/2	7	PVG020R7
Stainless Steel	1/2	9	PVG020R9

