

LUTZE TOP-T Fittings Adapter

Metric to NPT Adapters

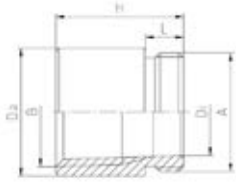

Adapter METRIC to NPT Characteristics

- Adapter from metric to NPT thread

Specifications

External thread	Metric EN 60423
Internal thread	NPT ANSI B1.20.1
Temperature range	up to +200°C/+392°F
Material	Brass, nickel plated

Part No.	Thread A	Thread B	L mm	H mm	Da mm	Di mm
----------	----------	----------	------	------	-------	-------

METRIC TO NPT

AMM16-12	M16x1.5	NPT 1/2"	6.5	24.5	24	11
AMM20-12	M20x1.5	NPT 1/2"	8	26	24	15
AMM25-34	M25x1.5	NPT 3/4"	8	26	30	18
AMM32-34	M32x1.5	NPT 3/4"	8	26	35	23
AMM32-10	M32x1.5	NPT 1"	8	29	37	27

Locknut sold separately

Specifications are subject to change without prior notice