

TIMKEN

The Timken Company
 4500 Mt Pleasant St. NW
 N. Canton, OH 44720
 Phone: (234) 262-3000
 E-Mail: CustomerCAD@timken.com • Web site: www.timken.com

Timken Part Number M88048 - M88010, Tapered Roller Bearings - TS (Tapered Single) Imperial

This is the most basic and most widely used type of tapered roller bearing. It consists of two main separable parts: the cone (inner ring) assembly and the cup (outer ring). It is typically mounted in opposing pairs on a shaft.

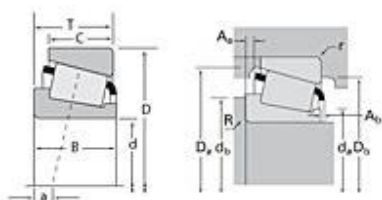

[Specifications](#) | [Dimensions](#) | [Abutment and Fillet Dimensions](#) | [Basic Load Ratings](#) | [Factors](#)

Specifications

| | |
|-------------------------|---------------------|
| Series | M88000 |
| Cone Part Number | M88048 |
| Cup Part Number | M88010 |
| Design Units | Imperial |
| Bearing Weight | 0.80 lb 0.400 Kg |
| Cage Type | Stamped Steel |

Dimensions

| | |
|-------------------------------|------------------------|
| d - Bore | 1.3125 in 33.338 mm |
| D - Cup Outer Diameter | 2.6875 in 68.263 mm |

| | |
|--------------------------|------------------------|
| B - Cone Width | 0.8750 in 22.225 mm |
| C - Cup Width | 0.6875 in 17.463 mm |
| T - Bearing Width | 0.8750 in 22.225 mm |

Abutment and Fillet Dimensions

| | |
|--|----------------------|
| R - Cone Backface "To Clear" Radius¹ | 0.03 in 0.760 mm |
| r - Cup Backface "To Clear" Radius² | 0.060 in 1.52 mm |
| da - Cone Frontface Backing Diameter | 1.62 in 41.15 mm |
| db - Cone Backface Backing Diameter | 1.67 in 42.42 mm |
| Da - Cup Frontface Backing Diameter | 2.60 in 66.00 mm |
| Db - Cup Backface Backing Diameter | 2.28 in 57.91 mm |
| Ab - Cage-Cone Frontface Clearance | 0.06 in 1.5 mm |
| Aa - Cage-Cone Backface Clearance | 0.05 in 1.3 mm |
| a - Effective Center Location³ | -0.11 in -2.80 mm |

Basic Load Ratings

| | |
|---|----------------------|
| C90 - Dynamic Radial Rating (90 million revolutions)⁴ | 4450 lbf 19800 N |
| C1 - Dynamic Radial Rating (1 million revolutions)⁵ | 17100 lbf 76300 N |
| C0 - Static Radial Rating | 17400 lbf 77400 N |
| C_{a90} - Dynamic Thrust Rating (90 million revolutions)⁶ | 4160 lbf 18500 N |

Factors

| | |
|---|--------|
| K - Factor⁷ | 1.07 |
| e - ISO Factor⁸ | 0.55 |
| Y - ISO Factor⁹ | 1.1 |
| G1 - Heat Generation Factor (Roller-Raceway) | 19.4 |
| G2 - Heat Generation Factor (Rib-Roller End) | 10 |
| Cg - Geometry Factor | 0.0771 |

¹ These maximum fillet radii will be cleared by the bearing corners.

² These maximum fillet radii will be cleared by the bearing corners.

³ Negative value indicates effective center inside cone backface.

⁴ Based on 90×10^6 revolutions L_{10} life, for The Timken Company life calculation method. C_{90} and C_{a90} are radial and thrust values.

⁵ Based on 1×10^6 revolutions L_{10} life, for the ISO life calculation method.

⁶ Based on 90×10^6 revolutions L_{10} life, for The Timken Company life calculation method. C_{90} and C_{a90} are radial and thrust values for a single-row, $C_{90(2)}$ is the two-row radial value.

⁷ These factors apply for both inch and metric calculations. Consult your Timken representative for instruction on use.

⁸ These factors apply for both inch and metric calculations. Consult your Timken representative for instruction on use.

⁹ These factors apply for both inch and metric calculations. Consult your Timken representative for instruction on use.

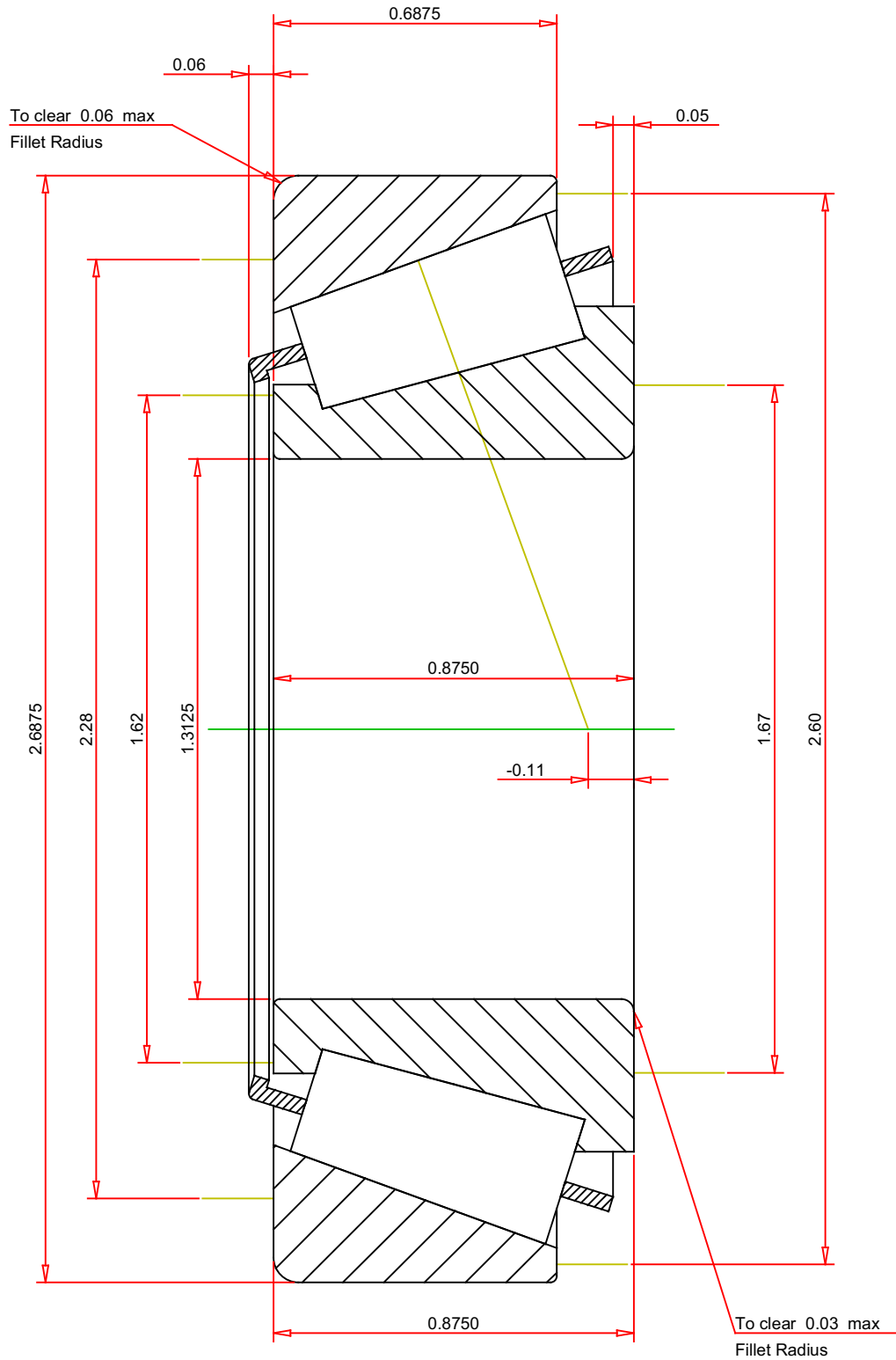

IMPERIAL UNITS

| | |
|---------------------------|------------|
| ISO Factor - e | 0.55 |
| ISO Factor - Y | 1.1 |
| Bearing Weight | 0.8 lb |
| Number of Rollers Per Row | 18 |
| Effective Center Location | -0.11 inch |

TIMIKEN®

THE TIMKEN COMPANY
NORTH CANTON, OHIO USA

M88048 - M88010
TS BEARING ASSEMBLY

| | |
|------------------------------|-----------|
| K Factor | 1.07 |
| Dynamic Radial Rating - C90 | 4450 lbf |
| Dynamic Thrust Rating - Ca90 | 4160 lbf |
| Static Radial Rating - C0 | 17400 lbf |
| Dynamic Radial Rating - C1 | 17100 lbf |

Every reasonable effort has been made to ensure the accuracy of the information contained in this writing, but no liability is accepted for errors, omissions or for any other reason.

FOR DISCUSSION ONLY