

iVu Series C-Mount Lens Enclosure



Datasheet

Supports standard C-mount lenses



- Mounts directly to iVu, iVu Color and iVu BCR C-mount lens models to create an IP67 device
- Rugged, waterproof housing, rated IEC IP67
- Available in long or short versions for varying lens and spacer configurations



WARNING:

- **Do not use this device for personnel protection**
- Using this device for personnel protection could result in serious injury or death.
- This device does not include the self-checking redundant circuitry necessary to allow its use in personnel safety applications. A device failure or malfunction can cause either an energized (on) or de-energized (off) output condition.

C-Mount Lens Enclosure Models

Model	Description
IVUSLC50-P	Sealed C-mount lens enclosure
IVUSLC75-P	

Specifications

Construction

Housing: ABS
Window: Acrylic

Environmental Rating

IEC IP67 when installed on iVu C-Mount devices

Outside Dimensions

IVUSLC50-P: 54 mm diameter by 33 mm long overall (2.13 in inches diameter by 1.30 inches long)

IVUSLC75-P: 54 mm diameter by 60 mm long overall (2.13 in inches diameter by 2.36 inches long)

Installing the Lens Enclosure

Before installing this lens enclosure, Banner recommends that a light filter be installed behind the lens. The filter improves image quality by reducing unwanted ambient light.

1. Install and focus the lens.
2. Thread on lens enclosure until it is seated against the sensor. Take care not to over tighten.

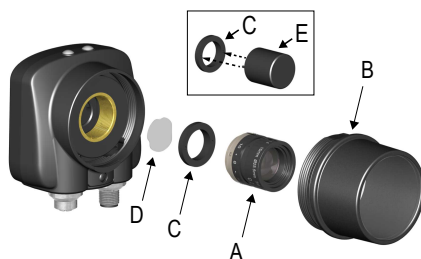

- A C-Mount Lens
- B Lens Enclosure
- C Retainer Ring
- D Filter
- E Filter Retainer Ring Tool



Note: Filter kits are available separately.



Banner Engineering Corp. Limited Warranty

Banner Engineering Corp. warrants its products to be free from defects in material and workmanship for one year following the date of shipment. Banner Engineering Corp. will repair or replace, free of charge, any product of its manufacture which, at the time it is returned to the factory, is found to have been defective during the warranty period. This warranty does not cover damage or liability for misuse, abuse, or the improper application or installation of the Banner product.

THIS LIMITED WARRANTY IS EXCLUSIVE AND IN LIEU OF ALL OTHER WARRANTIES WHETHER EXPRESS OR IMPLIED (INCLUDING, WITHOUT LIMITATION, ANY WARRANTY OF MERCHANTABILITY OR FITNESS FOR A PARTICULAR PURPOSE), AND WHETHER ARISING UNDER COURSE OF PERFORMANCE, COURSE OF DEALING OR TRADE USAGE.

This Warranty is exclusive and limited to repair or, at the discretion of Banner Engineering Corp., replacement. **IN NO EVENT SHALL BANNER ENGINEERING CORP. BE LIABLE TO BUYER OR ANY OTHER PERSON OR ENTITY FOR ANY EXTRA COSTS, EXPENSES, LOSSES, LOSS OF PROFITS, OR ANY INCIDENTAL, CONSEQUENTIAL OR SPECIAL DAMAGES RESULTING FROM ANY PRODUCT DEFECT OR FROM THE USE OR INABILITY TO USE THE PRODUCT, WHETHER ARISING IN CONTRACT OR WARRANTY, STATUTE, TORT, STRICT LIABILITY, NEGLIGENCE, OR OTHERWISE.**

Banner Engineering Corp. reserves the right to change, modify or improve the design of the product without assuming any obligations or liabilities relating to any product previously manufactured by Banner Engineering Corp. Any misuse, abuse, or improper application or installation of this product or use of the product for personal protection applications when the product is identified as not intended for such purposes will void the product warranty. Any modifications to this product without prior express approval by Banner Engineering Corp will void the product warranties. All specifications published in this document are subject to change; Banner reserves the right to modify product specifications or update documentation at any time. Specifications and product information in English supersede that which is provided in any other language. For the most recent version of any documentation, refer to: www.bannerengineering.com.

For patent information, see www.bannerengineering.com/patents.