

# EAO – Your Expert Partner for Human Machine Interfaces

## 84-6831.2B40 - Stop switch complete grey

### 84-6831.2B40 - Stop switch complete grey

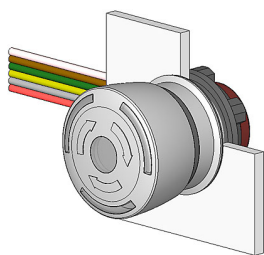

*Attention: The preview is based on a sample product. This can differ from your current configuration.*

#### Mounting

Mounting cut-out	Ø 22,3 mm
Design	raised
Behind panel depth	13,5 mm

#### Front

Front dimension	Ø 32 mm
Front shape	round

#### Other Attributes

Weight	0,036 kg
Operating voltage	5 ... 30 V DC
Operation current	9.7 ... 12.4 mA

#### Operating-/Indication part

Lens material	Plastic
Lens colour	grey
Lens profile	Mushroom
Lens optics	opaque

#### IP-Rating

Front protection	IP65
------------------	------

#### Connection Method

Terminal	Flat ribbon cable
----------	-------------------

#### Actuator

Switching action	Maintained
------------------	------------

#### Switching element

Switching system	Slow-make switching element
Switching voltage	250 V AC/DC
Switching current	5 A
Contacts	1 NC + 1 NO
Contact material	gold-plated silver

#### Illumination

LED colour	red
------------	-----

#### Function

Stop switch
-------------

# EAO – Your Expert Partner for Human Machine Interfaces

## 84-6831.2B40 - Stop switch complete grey

### Dimensions

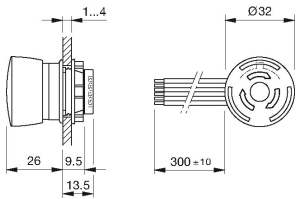

F1 = Flat ribbon cable

### Mounting cut-outs

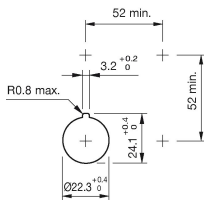

### Wiring diagram

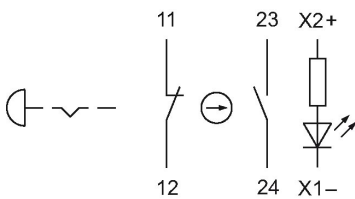

### Component layout

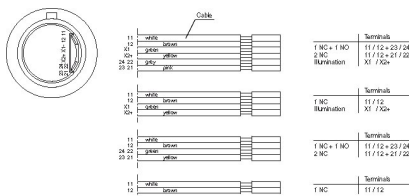

### Additional information

Twist to unlock clockwise

Position indication ring black

Standard version: Flat ribbon-cable length 300 mm or plug-in terminal 2.8 x 0.5 mm

Other options on request: Customisation of flat ribbon-cable and connectors

Luminosity and wave length variations caused by LED manufacturing processes may cause slight differences regarding the illumination

### Legend

Contacts: NC = Normally closed, NO = Normally open