

CATALOG NUMBERS:  
**P60-CACP-GFCI, P60-CACP-GFI-AL**

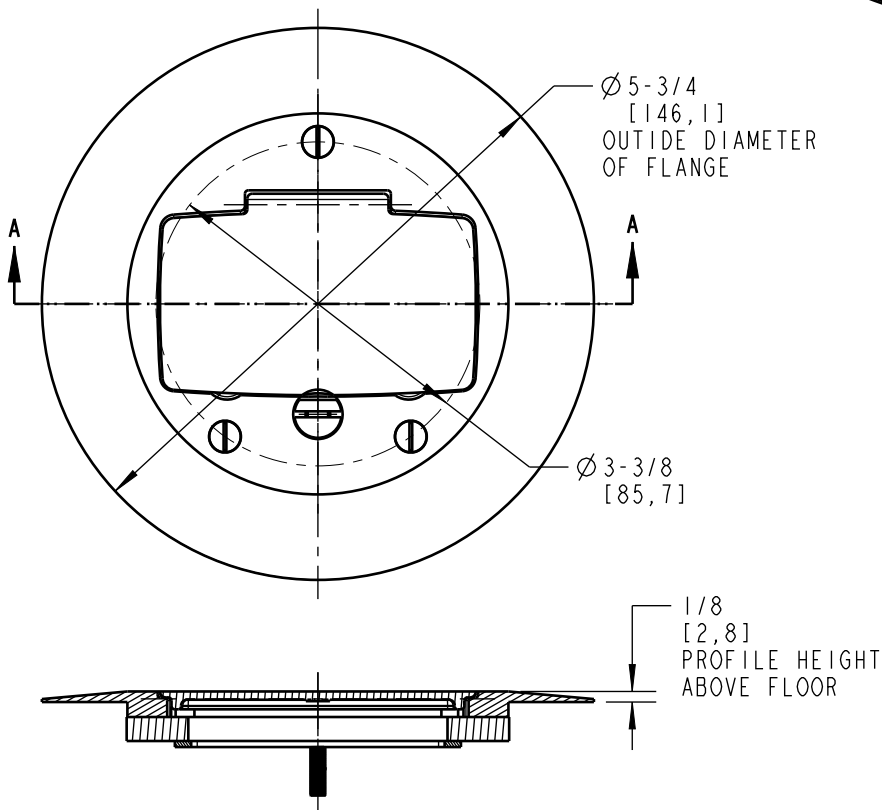
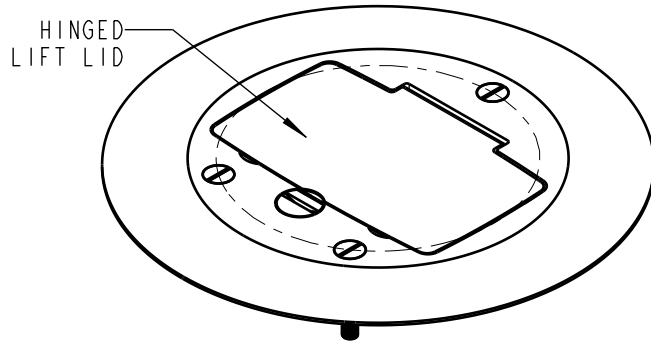

SECTION A-A

**FEATURES:**

1. INTEGRATED CARPET PLATE AND GFCI FLOOR PLATE IN ONE UNIT
2. FOR USE WITH 68P, 68 AND 600 SERIES FLOOR BOXES
2. AVAILABLE IN SOLID BRASS OR ALUMINUM MATERIAL
3. FURNISHED WITH SEALING GASKET AND MATCHING 8-32 X 1" SCREWS

CATALOG NUMBERS	MATERIAL	FINISH
P60-CACP-GFCI	SOLID BRASS	BRASS
P60-CACP-GFI-AL	ALUMINUM	ALUMINUM

**GENERAL NOTES**

1. ALL DIMENSIONS ARE FOR REFERENCE ONLY.
2. DIMENSIONS IN BRACKETS [ ] ARE IN METRIC UNITS.

**REVISIONS**

A SEE ECN ( \*\*\*\* ) FOR APPROVAL SIGNATURES & RELEASE DATE.  
 PROJECT NO: \*\*\*\*

www.tnb.com

**Thomas & Betts**  
 A Member of the ABB Group

DESCRIPTION: **P60-CACP-GFCI, P60-CACP-GFI-AL  
 CARPET PLATE, GFCI**

ORIGINAL PROJECT NO / ECN NO  
 003V001056 / ECN000083908

SHEET NO:  
 1 OF 1

REV. NO:  
**A**

DRAWING NO:  
**WSD-002611**