

INLINE MINI® SPLASHPROOF FUSE HOLDER

For MINI® Style Blade Fuses



Specifications

Housing:	Thermoplastic (UL 94-V0, heat resistant)
Color:	Black
IP Rating:	IP67
Voltage Rating:	32 V DC

Recommended Fuse

MINI® Series
Blade Fuses



Description

Used with MINI / FK1 Fuse. Includes protective cover for harsh environment. This product is compatible with a MINI diode. Protected to a rating of IP67.

Features and Benefits

- Heat-Resistant TPV molded body
- IP67 rating with cover for use in harsh environments
- Tin-plated copper contacts for corrosion resistance
- Pre-crimped wire leads for application flexibility

Dimensions in mm

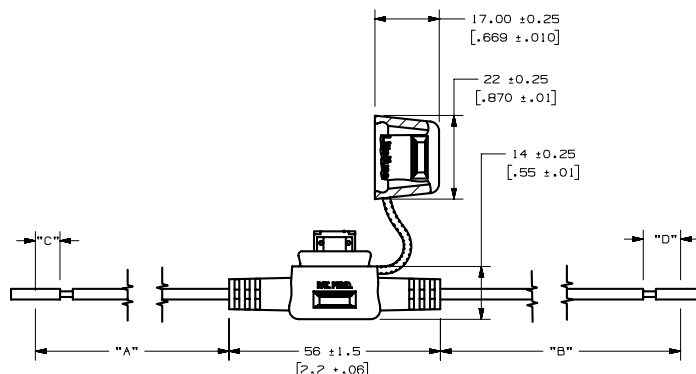

Ordering Information

PART NUMBER	DESCRIPTION	PACKAGE SIZE	CURRENT RATING	VOLTAGE RATING
0FHM0001ZXJ	14 AWG / GXL Wire / Black / 107-107 mm	1000	20A	32V DC
0FHM0001SXJ	14 AWG / GXL Wire / Black / 107-107 mm	20	20A	32V DC
0FHM0001XP	14 AWG / GXL Wire / Black / 107-107 mm (RETAIL)	5	20A	32V DC
0FHM0001HXGLO	12 AWG / GXL Wire / Orange / Translucent GLO cap	100	30A	32V DC
0FHM0001XPGLO	12 AWG / GXL Wire / Orange / Translucent GLO cap	5	30A	32V DC
0FHM0002ZXJ	12 AWG / GXL Wire / Orange / 107-107 mm	1000	30A	32V DC
0FHM0002SXJ	12 AWG / GXL Wire / Orange / 107-107 mm	20	30A	32V DC
0FHM0002XP	12 AWG / GXL Wire / Orange / 107-107 mm (RETAIL)	5	30A	32V DC
0FHM0003UXJK	16/14 AWG / GXL Wire / Red / 540-165 mm	500	20A	32V DC
0FHM0003ZXJB	16 AWG / GXL Wire / Black / 93-93 mm	1000	20A	32V DC
0FHM0003ZXJH	16 AWG / GXL Wire / Orange / 277-277 mm	1000	20A	32V DC
0FHM0003ZXJR	16 AWG / GXL Wire / Black / 93-93 mm	1000	20A	32V DC
0FHM0003ZXJS	18 AWG / TXL Wire / Black / 94-94 mm	1000	10A	32V DC
0FHM0003ZXJT-F5	18 AWG / TXL Wire / Black / 94-94 mm - w/ 5A fuse	1000	5A	32V DC
0FHM0003ZXJU	16 AWG / GXL Wire / Orange / 305-305 mm	1000	20A	32V DC