

PRODUCT INFORMATION PACKET

Model No: 056H17T2022
Catalog No: Y606
1/8, 1800, TENV, 56C, 3/60/230
1000:1 Speed Ratio



Regal and Marathon are trademarks of Regal Beloit Corporation or one of its affiliated companies.

©2018 Regal Beloit Corporation, All Rights Reserved. MC017097E





Nameplate Specifications

Output HP	0.13 Hp	Output KW	0.09 kW
Frequency	60 Hz	Voltage	230 V
Current	0.66 A	Speed	1725 rpm
Service Factor	1	Phase	3
Efficiency	65.5 %	Duty	Continuous
Insulation Class	H	Design Code	INV
KVA Code	R	Frame	56C
Enclosure	Totally Enclosed Non Ventilated	Overload Protector	No
Ambient Temperature	40 °C	Drive End Bearing Size	6203
Opp Drive End Bearing Size	6203	UL	Recognized
CSA	Y	CE	Y
IP Code	43		

Technical Specifications

Electrical Type	Squirrel Cage Inverter Duty	Starting Method	Inverter Only
Poles	4	Rotation	Reversible
Mounting	Round	Motor Orientation	Horizontal
Drive End Bearing	Ball	Opp Drive End Bearing	Ball
Frame Material	Rolled Steel	Shaft Type	NEMA 56
Overall Length	9.16 in	Frame Length	5.50 in
Shaft Diameter	0.625 in	Shaft Extension	2.06 in
Assembly/Box Mounting	F1 Only		
Outline Drawing	A-SS400214-550	Connection Diagram	A-EE7300HX

This is an uncontrolled document once printed or downloaded and is subject to change without notice. Date Created: 06/29/2018

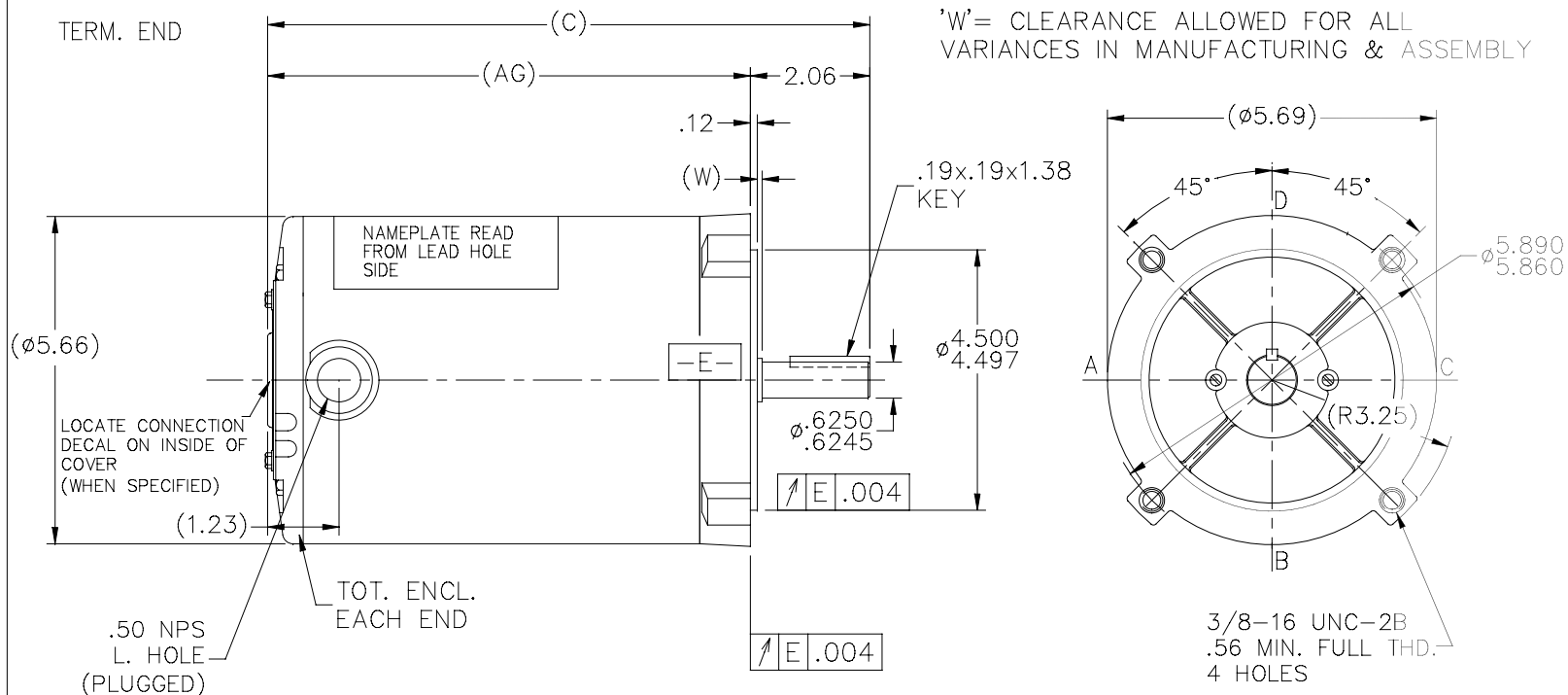

DASH		C	AG		DASH		C	AG		DASH		C	AG	
525	10-20-2004	8.91	6.85											
550	01-16-2002	9.16	7.10		650		10.16	8.10		725		10.91	8.85	
600		9.66	7.60		675		10.41	8.35		750		11.16	9.10	
625		9.91	7.85		700		10.66	8.60		775		11.41	9.35	

6	CONNECTION DECAL NOTE ADDED PER ECO-0089570	KIR 11/26/15	KK	TOLERANCES UNLESS SPECIFIED		DRAWN BRH 05-17-1996
5	REVISED "C" & "AG" DIMS ISAAC10-2047	TJW 7/27/2010	CTO	DEC. INCHES		CHK ML 05-21-1996
4	ADDED DASH 525 MU62602	RJW 10-20-2004	MJS	.X ±.1	APPD SAT 05-21-1996	
3	REDRAWN IN AUTOCAD	TAT 07-06-2004	ML	.XX ±.03	SCALE 3=8	
2	REVISED NAMEPLATE LOCATION CN 34681	NJS 02-19-2002		.XXX ±.005	REF	
1	NEW DRAWING 4397198	BRH 05-24-1996		.XXXX ±.0005	FMF	
NO.	REVISION	BY & DATE	CHK	ANG ±.30"	PREV	
THIS DRAWING IN DESIGN AND DETAIL IS OUR PROPERTY AND MUST NOT BE USED EXCEPT IN CONNECTION WITH OUR WORK ALL RIGHTS OF DESIGN AND INVENTION ARE RESERVED THIS IS AN ELECTRONICALLY GENERATED DOCUMENT - DO NOT SCALE THIS PRINT				RFP	CAD FILE ss400214	SIZE A
				DIST WP		DRAWING NO. SS400214
						PAGE 3 OF 6
						REV. 6

THREE PHASE – SINGLE VOLTAGE MOTOR

TO REVERSE ROTATION:
INTERCHANGE ANY TWO LINE
LEAD CONNECTIONS

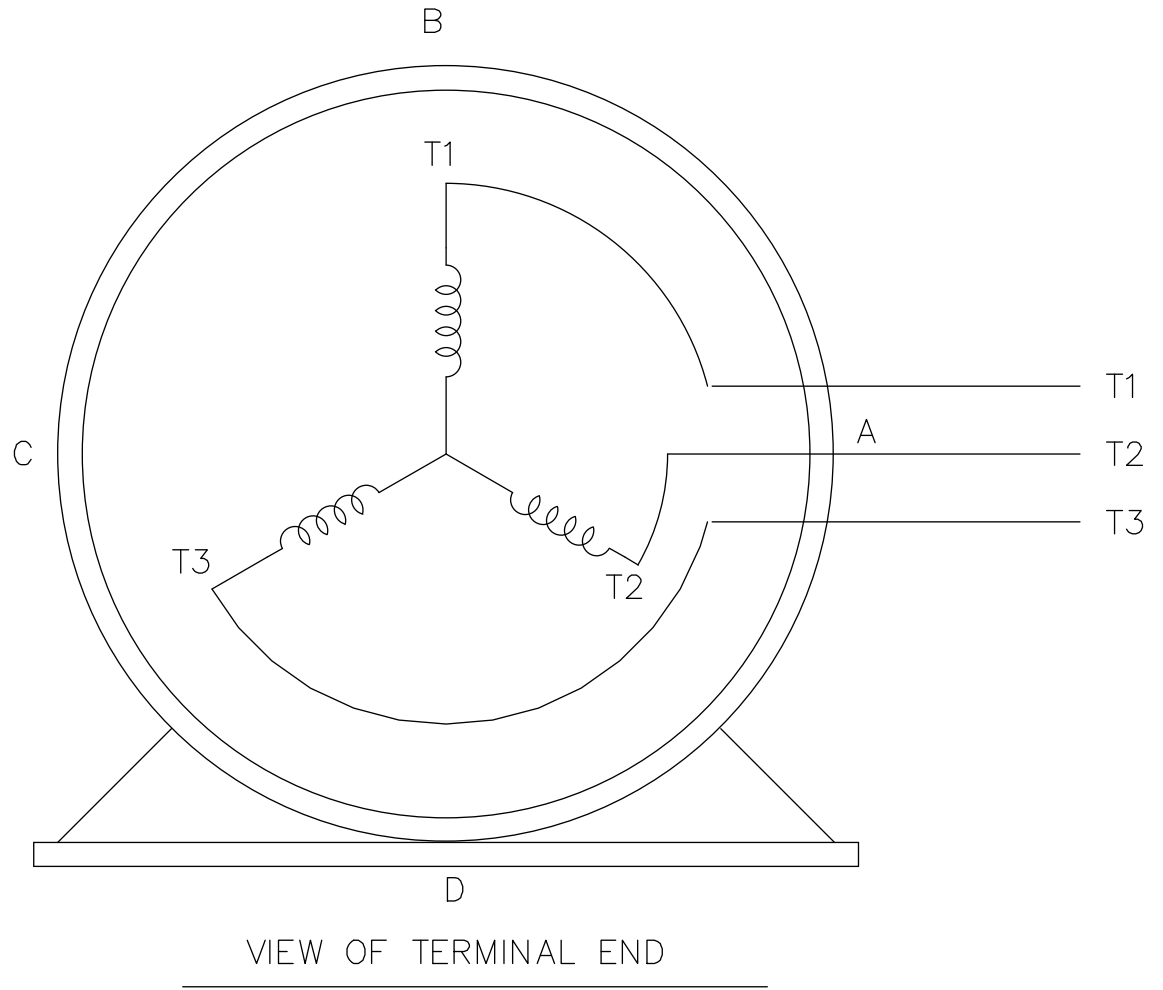

TERMINAL BOARD
WHEN SPECIFIED

L1 TO 1
L2 TO 2
L3 TO 3

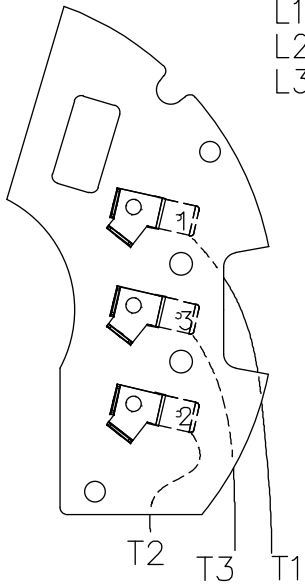

DRAWN	NJS 06-18-2001
CHK	ML 06-19-2001
APPD	GK 06-19-2001
SCALE	1=1
REF	
FMF	
PREV	

NO.	REVISION	BY & DATE	CHK	ANG	TOLERANCES UNLESS SPECIFIED	
					DEC.	INCHES
3	UPDATED TERMINAL BOARD COMMENT	UD 11/12/13	BV	.XX	±.02	
2	REDRAWN IN AUTOCAD	TAT 08-02-2004	ML	.XXX	±.005	
1	NEW DRAWING	MU37179 NJS 06-19-2001		.XXXX	±.0005	
					±7'30"	

TITLE	CONNECTION DIAGRAM SINGLE VOLT – 3φ MOTOR
MAT'L.	
FINISH	

THIS DRAWING IN DESIGN AND DETAIL IS OUR PROPERTY AND MUST NOT BE USED EXCEPT IN CONNECTION WITH OUR WORK ALL RIGHTS OF DESIGN AND INVENTION ARE RESERVED THIS IS AN ELECTRONICALLY GENERATED DOCUMENT – DO NOT SCALE THIS PRINT

RFP	
DIST	

CAD FILE	ee7300hx
----------	----------

SIZE	DRAWING NO.	PAGE	OF	REV.
A	EE7300HX			3

NONE	P/N	NONE	
NONE	NONE		
NONE FT-LB	NONE V	NONE Hz	

DATE: 06/28/2017 02:02:50 AM
FORM 3531 REV.3 02/07/99
** Subject to change without notice.