

THE INFORMATION CONTAINED IN THIS DRAWING IS THE SOLE PROPERTY OF L-COM, INC. ANY REPRODUCTION IN PART OR WHOLE WITHOUT THE WRITTEN PERMISSION OF L-COM, INC. IS PROHIBITED.

REVISONS			
REV	DESCRIPTION	DATE	APPROVED
A	DRAWING REPLACES TDG1026A-6C-OD1 AT REV B	11/14/14	D. CASTRO
.	.	.	.
.	.	.	.

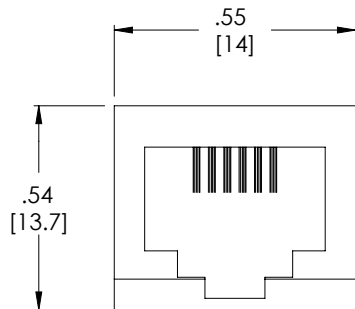

RJ12 JACK
(6P6C)

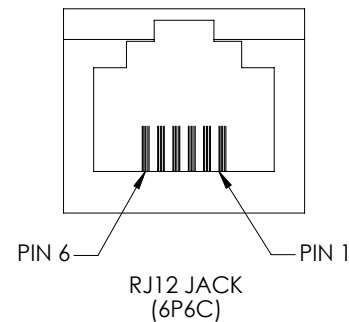
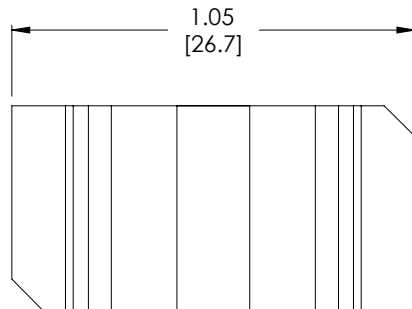

RJ12 JACK
(6P6C)

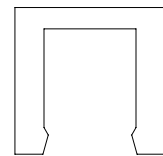

TDG1026A-6CBK
RETAINER

PANEL THICKNESS	NO. OF CLIPS
LESS THAN .050" [1.25 MM]	4
.050" TO .070" [1.25 TO 1.78 MM]	3
.070" TO .090" [1.78 TO 2.29 MM]	2

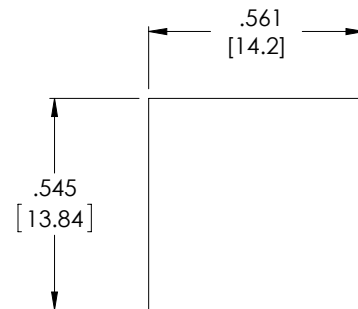

RECOMMENDED
PANEL CUT-OUT

SPECIFICATIONS:

UL94V-0 COMPLIANT
CSA CERTIFIED: CUL
CATEGORY 3 RATED

MATERIALS:

HOUSING: ABS
COLOR: IVORY
CONTACTS: PHOSPHOR BRONZE
CONTACT PLATING: 30 μINCHES GOLD OVER NICKEL

ELECTRICAL:

CURRENT RATING: 1.5 AMP MAX
VOLTAGE RATING: 1000 VOLTS

ENVIRONMENTAL:

OPERATING TEMPERATURE RANGE: 0°C TO 60°C

APPLICATION:

FEED THROUGH COUPLER
RETAINER CLIP (P/N TDG1026A-6CBK, ORDERED SEPARATELY)
REQUIRED FOR PANEL MOUNTING. USE TABLE TO
DETERMINE HOW MANY CLIPS ARE NEEDED.

MISCELLANEOUS:

DIMENSIONS ARE FOR REFERENCE ONLY.
COUPLER SHALL BE TESTED FOR CONTINUITY.
COUPLER SHALL BE INDIVIDUALLY PACKAGED IN
ACCORDANCE WITH L-COM SPECIFICATION PS-0031.

REGULATORY COMPLIANCE:

CE2011/65/EU(RoHS DIRECTIVE)

UNLESS OTHERWISE SPECIFIED, DIMENSIONS ARE IN INCHES [mm] OVERALL CABLE LENGTH TOLERANCE: ≤12 [305] = +1 [25] / -0 >12 [305] ≤60 [1524] = +2 [51] / -0 >60 [1524] ≤120 [3048] = +4 [102] / -0 >120 [3048] ≤300 [7620] = +6 [152] / -0 >300 [7620] = +5% / -0% ALL OTHER DIMENSIONAL TOLERANCES: .X = ±.2 [5.08] .XX = ±.02 [51] .XXX = ±.005 [13]	APPROVALS	DATE	45 BEECHWOOD DRIVE NORTH ANDOVER, MA 01845	
	DRAWN BY TJC	10/10/01		
	CHECKED BY TJC	10/12/01	CATEGORY	
	APPROVED BY CM	10/12/01	TELECOM/MODULAR	
PROJECTION 	CONFIGURATION DETAILS OF UNDIMENSIONED FEATURES MAY VARY		PRODUCT DESCRIPTION	
			PANEL MNT COUPLER 6X6 STRAIGHT	
COLOR VARIATIONS MAY OCCUR		SIZE A	FSCM NO. 43321	DWG. NO. TDG1026A-6C
		SCALE: NONE	CAD FILE: TDG1026A-6C.SLDDRW	REV. A
		SHEET 1 OF 1		