

OVERALL DIMENSIONS AND ORDERING CODES

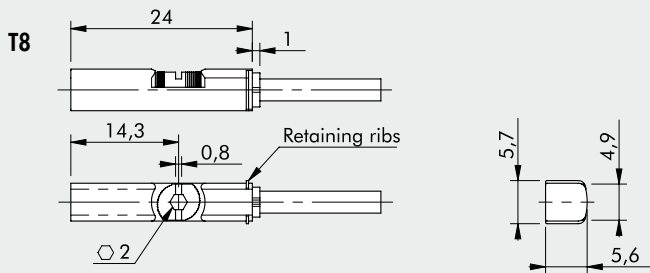
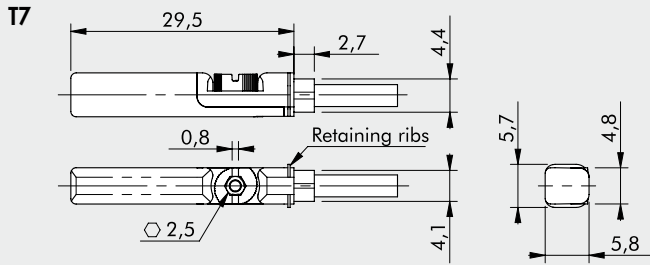

Code	Description
T7	
W095414	REED sensor, T7 SQUARE, 2 wires 2.5 m
W095415	REED sensor, T7 SQUARE, 2 wires 5 m
W095416	REED sensor, T7 SQUARE, 2 wires 10 m
W09541C	REED sensor, T7 SQUARE, 2 wires 2.5 m robotics
W095411	REED sensor, T7 SQUARE, 2 wires 300 mm M8 robotics
W095434	HALL sensor, T7 SQUARE, 3 wires 2.5 m
W095435	HALL sensor, T7 SQUARE, 3 wires 5 m
W09543C	HALL sensor, T7 SQUARE, 3 wires 2.5 m robotics
W095431	HALL sensor, T7 SQUARE, 3 wires 300 mm M8 robotics

T8 ATEX	
W0955A9	HALL sensor, T8 SQUARE, 3 wires ATEX 2 m SH.OV. robotics
T8 (for corrosive environments)	
W0952125396	HALL sensor, T8 SQUARE, 3 wires 2 m HCR
W0952129394	HALL sensor, T8 SQUARE, 3 wires 300 mm M8 HCR

Note: Not to be used with rodless cylinders Ø 25 having "V" guide.
For this type of cylinder use only the HS version of the oval type.

WIRING DIAGRAM

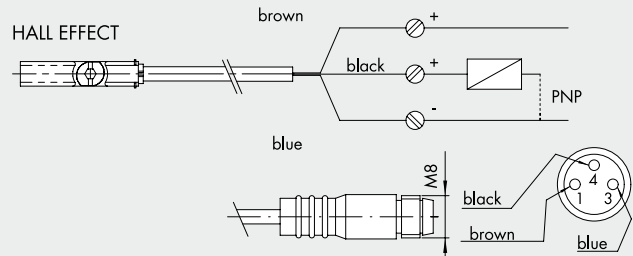
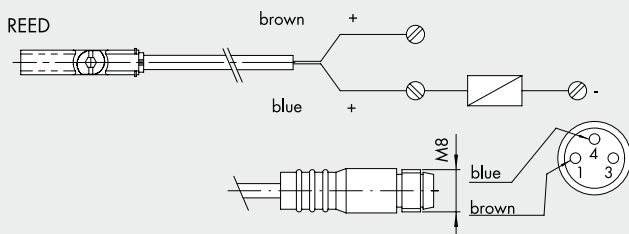

NOTES