

B Series

Industry Standard DIN Totalizing Counters

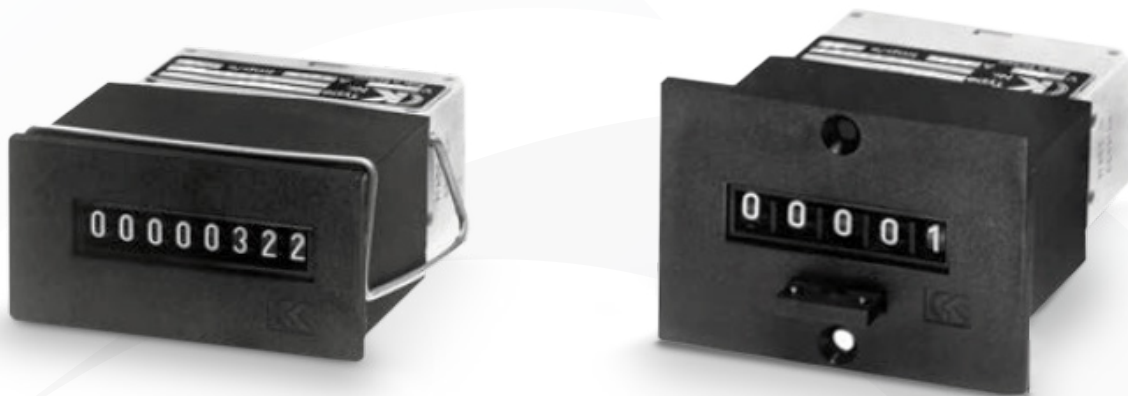

CE

The B Series are the perfect all-round counter. A general purpose, high performance/low cost counter for monitoring manufacturing processes, flow totals, test cycles where accurate count must be displayed even when power is lost. It utilizes an all plastic housing and frame to achieve lower cost without sacrificing quality. Count life is 200 million minimum with optional speeds to 50 counts per second possible. Spring clip or two screw mountings are standard.

Key Features

- 6 Digits with Reset
- 8 Digits Non-Reset
- Reversed Colored Number Wheels
- CE Certified
- Low Cost

Count Input

Voltages	Count per second	Time in millisecond on	Time in millisecond off	Pulse Ratio	Power Consumption	
					Count	Reset
DC	5	120	80	3:2	85mW	N/A
	10	60	40	3:2	1W	
	25	24	16	3:2	2W	
AC	18	27	120	1:1	2.9VA	N/A

Dimensions

0 Mount Style

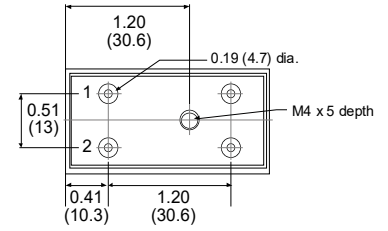
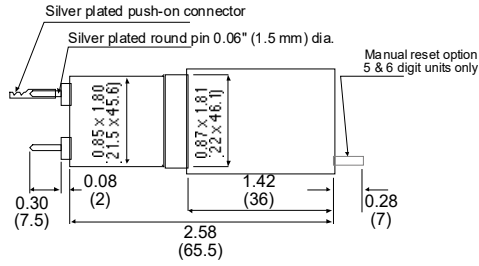
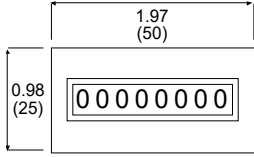

1 Mount Style

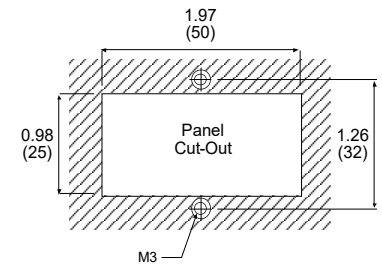
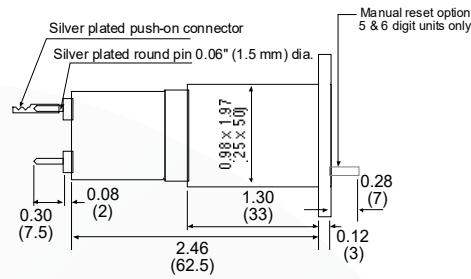
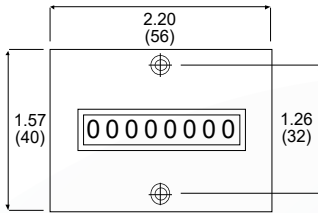

2 Mount Style

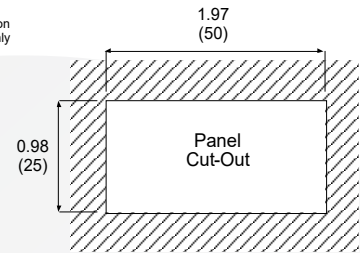
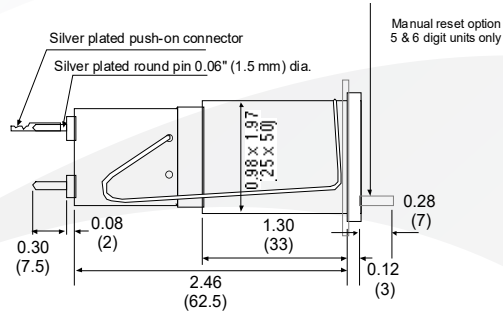
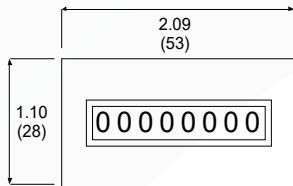

3 Mount Style

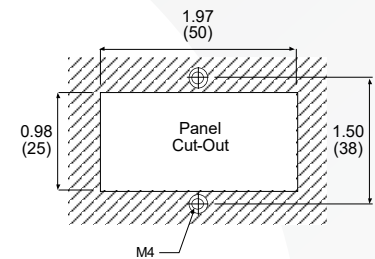
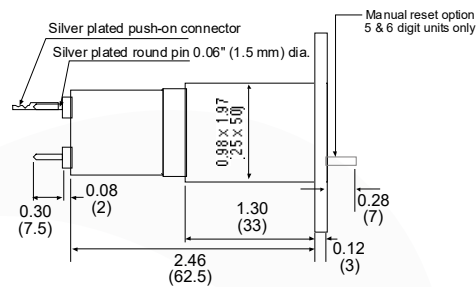
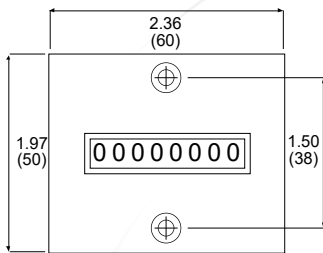

F1B Mount Style

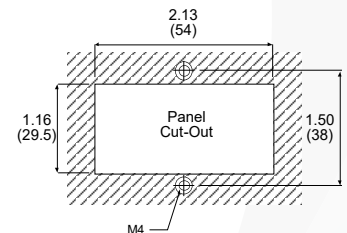
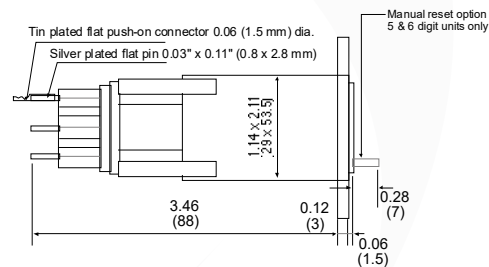
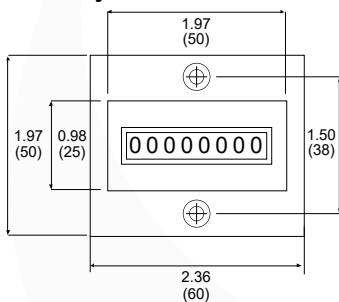

Specifications

Count Life:	200 million
Numbers:	.160" (4mm) high
Housing:	Black plastic, 6 or 8 digit
Connections:	.060" pins with push on connectors
Count Speed with DC:	10, 25 count/sec. (optional 50 counts/sec)
Count Speed with AC:	18 counts/sec.
Impulse Ratio:	60% on time, 40% off time (Min.).
Operating Voltage:	6, 12, 24, 48, 110, 220 VDC; 24, 48, 110, 220 VAC
Operating Temp.:	+23°F to +104°F (-5°C to +40°C)
Shock:	Unit meets IEC 068-2-27 for Shock Stability
Vibration:	Unit meets IEC 068-2-6 for Vibration
Approvals:	CE approved
Weight:	3 oz.
Max. Count Time:	Continuous 50/50 or 60/40, on/off

Part Number Ordering Chart

Example:

B 16 1 1 24 VDC 25 CPS

Series
B

Digits
16 6 digits
18 8 digits

Mounting
1 Screw panel
2 Spring clip
3 Large screw panel

Reset
0 Non-reset
1 Manual push button

Voltages (specify)
6, 12, 24, 48, 110 and 220 VDC
24, 48, 110 and 220 VAC

Count Speeds (specify)
5, 10, 25 CPS DC
18 CPS AC

Available Options (add to end of part number)
FL 6" Wire Leads

