

THE INFORMATION CONTAINED IN THIS DRAWING IS THE SOLE PROPERTY OF L-COM, INC. ANY REPRODUCTION IN PART OR WHOLE WITHOUT THE WRITTEN PERMISSION OF L-COM, INC. IS PROHIBITED.

REVISIONS			
REV	DESCRIPTION	DATE	APPROVED
A	INITIAL RELEASE	12/19/03	B.MAZEJKA
B	ECN 7386: ADDED [MM] DIMS, ROHS,UPDATED FORMAT & NOTES	4/17/14	D. CASTRO
C	ECN 9052 ADD FRONT-BACK SHELL DIVISION, ADD SHELL FINISH NOTES	01/16/18	B.PUCHASKI

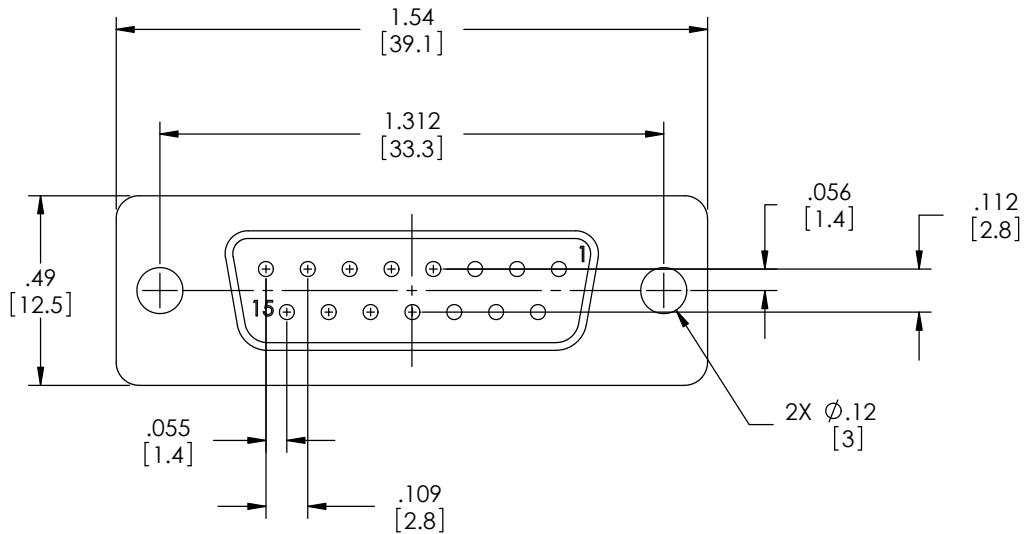
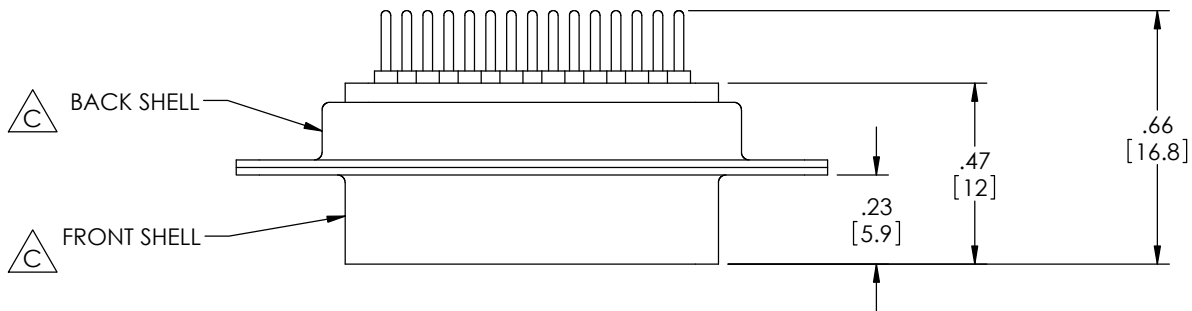

NOTES:

MATERIAL:

SHELL: COLD ROLLED STEEL
 CONTACTS: BRASS
 INSULATOR: THERMOPLASTIC PBT (UL 94V-0 RATED)

FINISH:

SHELL: FRONT SHELL: NICKEL PLATED, $\triangle C$
 BACK SHELL: TIN PLATED
 MATING CONTACTS: GOLD SELECTIVE PLATED

ELECTRICAL:

CURRENT RATING: 5 AMP
 DIELECTRIC WITHSTANDING VOLTAGE: 1000 VAC
 INSULATINON RESISTANCE: 1000 MΩ PER MINUTE @ 500 VDC
 CONTACT RESISTANCE: 20mΩ MAX

ENVIRONMENTAL:

OPERATIONAL TEMPERATURE RANGE: -55°C TO +105°C

COMPONENT SHALL BE INDIVIDUALLY PACKAGED IN ACCORDANCE WITH L-COM SPECIFICATION PS-0031.

REGULATORY COMPLIANCE:

CE2011/65/EU(RoHS DIRECTIVE)

UNLESS OTHERWISE SPECIFIED, DIMENSIONS ARE IN INCHES [mm] OVERALL CABLE LENGTH TOLERANCE: ≤12 [305] = +1 [25] / -0 >12 [305] ≤60 [1524] = +2 [51] / -0 >60 [1524] ≤120 [3048] = +4 [102] / -0 >120 [3048] ≤300 [7620] = +6 [152] / -0 >300 [7620] = +5% / -0% ALL OTHER DIMENSIONAL TOLERANCES: .X = ±.2 [5.08] .XX = ±.02 [51] .XXX = ±.005 [1.27]	APPROVALS DRAWN BY B.MAZEJKA CHECKED BY C.McCORMICK APPROVED BY D.PARHAM	DATE 12/18/2003 12/19/2003 12/19/2003	L-com Global Connectivity 45 BEECHWOOD DRIVE NORTH ANDOVER, MA 01845	
	CONFIGURATION DETAILS OF UNDIMENSIONED FEATURES MAY VARY		CATEGORY D-SUBMINIATURE	
	COLOR VARIATIONS MAY OCCUR		PRODUCT DESCRIPTION CONNECTOR, DB15F PCB	SCALE: NONE CAD FILE: SD15S-PC.SLDDRW SHEET 1 OF 1
	PROJECTION 	SIZE A	FSCM NO. 43321	DWG. NO. SD15S-PC REV. C