

Locking Devices



20 Amp Plugs, Connectors Flanged Devices and Receptacles

20A 125V, 250V, 277V AC, 480V AC and 600V AC Locking Devices,
2-Pole 3-Wire Grounding Inches (mm)

TECH·SPEC®



Rating	Cord Diameter	Description	Tripple Gripper		Flanged Devices Equipment Base with Nylon White Cup		Weather Protective Power Inlets	Single Nylon Receptacle, All Black
			Nylon Plug	Nylon Connector	Male	Female	Die Cast Aluminum Plate*	
NEMA L5-20, 20A 125V	.300"-.655" (7.6-16.6)	Black/White	70520NP	70520NC	70520MB	70520ER	70520MBWP	—
		All Black	70520NPB	70520NCB	—	—	—	70520FR
		Corrosion-Resistant Yellow/White	70520NPCR	70520NCCR	—	—	—	70520FRCR
		Isolated Ground Orange	—	—	—	—	—	70520IG
NEMA L6-20, 20A 250V	.300"-.655" (7.6-16.6)	Black/White	70620NP	70620NC	70620MB	70620ER	70620MBWP	70620FR
		Corrosion-Resistant Yellow/White	70620NPCR	70620NCCR	—	—	—	—
		Isolated Ground Orange	—	—	—	—	—	70620IG
NEMA L7-20, 20A 277V AC	.300"-.655" (7.6-16.6)	Black/White	70720NP	70720NC	70720MB	70720ER	—	70720FR
NEMA L8-20, 20A 480V AC	.300"-.950" (7.6-24.1)	Black/White	70820NP	70820NC	70820MB	70820ER	—	70820FR
NEMA L9-20, 20A 600V AC	.300"-.950" (7.6-24.1)	Black/White	70920NP	70920NC	70920MB	70920ER	—	70920FR

Note: *Supplied with gaskets, mounting screws and spring-loaded, self-closing lift cover.
See Section D for more information on isolated ground devices and Section J for more information on corrosion-resistant devices.
See page H-20 for weather protective boots for 20 amp nylon locking plugs.

Product Dimensions Inches (mm)

Plug	
A	2.86" (72.4)
B	1.89" (48.0)
C	2.13" (54.1)

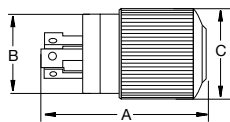

Connector	
A	3.90" (99.1)
B	1.89" (48.0)
C	2.13" (54.1)

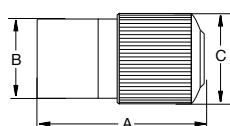

	Receptacle	Flanged Devices
	Single	Male/ Female
A	3.28" (83.3)	2.88" (73.2)
B	2.38" (60.5)	120°
C	1.56" (39.6)	2.00" (50.8)
D	1.70" (43.2)	2.02" (51.3)
E	2.67" (67.8)	2.05" (52.1)
F	1.24" (31.5)	(3) 0.19" (4.8)

Note: See page S-8 for horsepower ratings.

