

NOTE:

1. HOUSING MATERIAL: GLASS REINFORCED BLACK NYLON
2. TOOL WEIGHT: 32 oz.
3. INSTALLS HELLERMANNNTYTON TIES T50-T255.
4. TOOL REQUIRES NO SPECIAL OPERATOR MAINTENANCE.
5. FOR REPLACEMENT BLADE ORDER PART # MK9P-109
6. SAFETY GLASSES MUST BE WORN AT ALL TIMES.
7. AIR PRESSURE: 90 PSI MAX (6 BAR)

8. USE NON-LUBRICATED AIR ONLY.
9. STANDARD = T50, T80 TIES (.18" WIDE)
HEAVY = T120(.30 WIDE), T150(.35 WIDE);
T250; T255 (.50 WIDE)
10. OPTIONAL: REMOVE PAN HEAD SCREW FROM "UNLOCK" POSITION AND PLACE IN "LOCK" POSITION TO LOCK FINE ADJUST KNOB TO CAM KNOB.

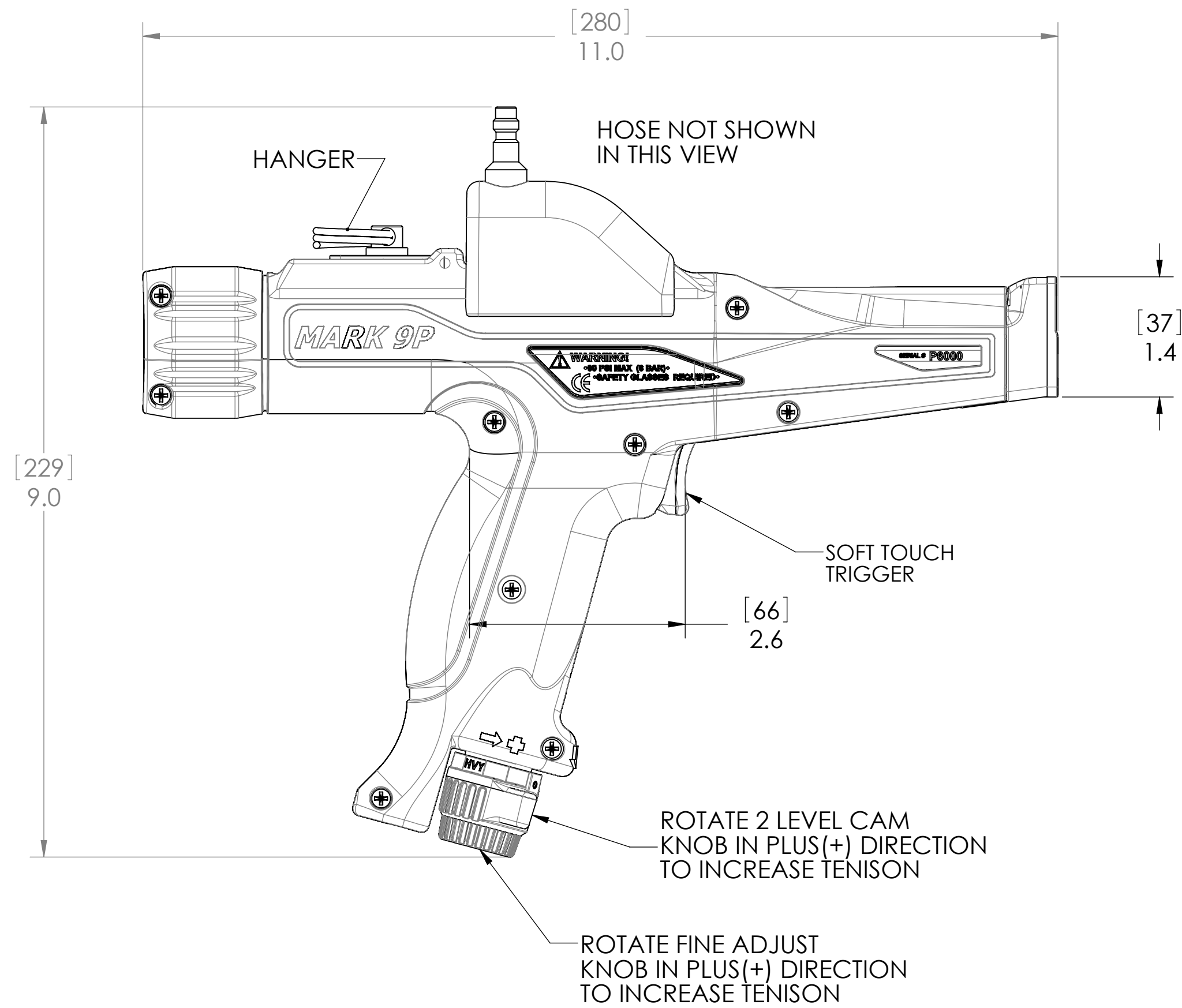
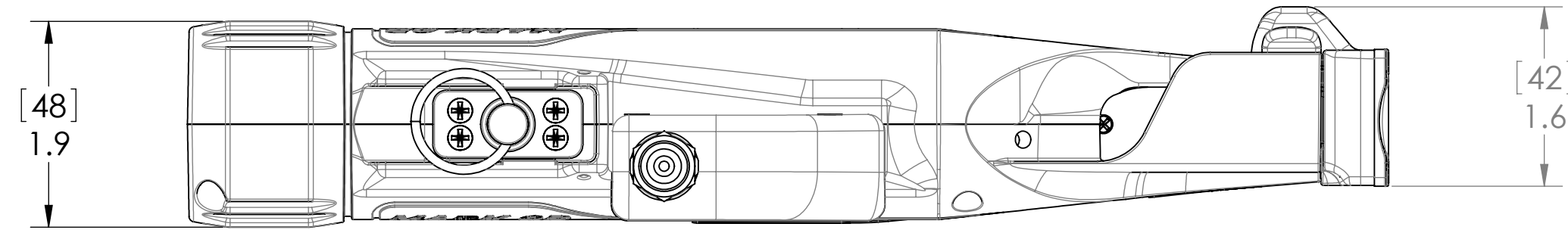

CAM KNOB PUSHER FOR LOW TORQUE EASE OF ADJUSTMENT

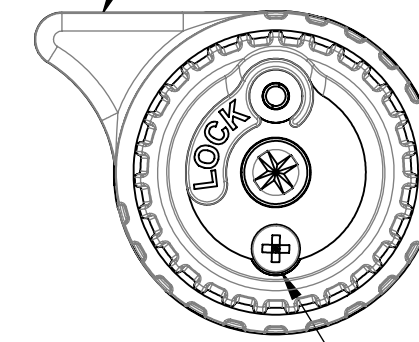

FINE ADJUST KNOB SCALE 2:1

SEE NOTE 10

QUICK CONNECT FITTING 1/4" PLUG TO AIR SUPPLY

10" LONG 1/8" ID BRAIDED HOSE

FAST DISCONNECT SOCKET

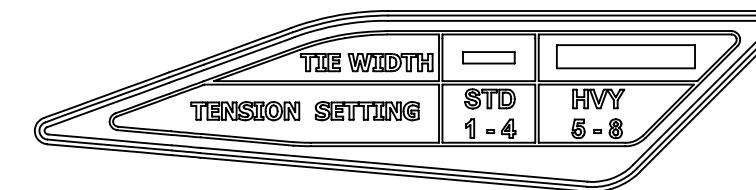

LABEL, TENSION SETTINGS SCALE 2:1



LABEL, WARNING SCALE 2:1

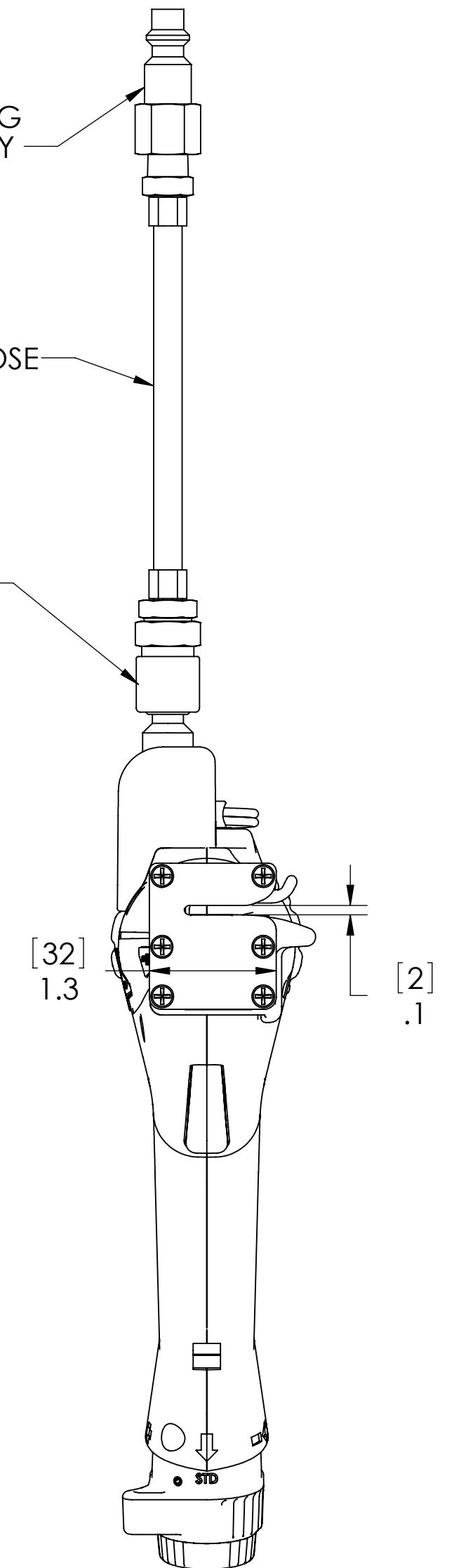

INVENTORS

HellermannTyton®

ALL PROPRIETARY RIGHTS IN THE SUBJECT MATTER SHOWN ON THIS DRAWING ARE EXCLUSIVE PROPERTY OF HELLERMANNNTYTON

name date city, state

NOTES

REVISION

DR level	02
W by	WKL
I date	1/11/2012
G ECN #	012010
part level	-

DIMENSIONS

.XXXX =	[±.013]/±.0005
.XXX =	[±.13]/±.005
.XX =	[±.3]/±.01
.X =	[±.8]/±.03
∠	±0.5°
unless otherwise specified	
units	[millimeters]/inches

PART

number	MK9PUA	phase	Production
name			
CUSTOMER DRAWING			
MK9PUA (110-90300)			
material			

DRAWING

format	C	SW 2010	scale	3:4
version	N			
computer file name	TS2097200CST_02		previous drawing number	
drawn	AAC	checked	WKL	approved
	05/24/2007		05/24/2007	
type	Customer	sheet 1 of 1		
number	TS2097200CST			